

NOTE: BREAK ALL CORNERS WITH 0.015" (.38 MM) RADIUS UNLESS OTHERWISE NOTED. STANDARD TOLERANCES TO APPLY UNLESS OTHERWISE SPECIFIED.

CUSTOMER	CAN ART STD	DIE No.	ES04057	REV. No.	0
DESCRIPTION	1.750 x 1.750 x 0.125 CHANNEL	CUSTOMER PART No.	QUOTE No.	PROPOSAL No.	
			24-0663-1	S-47094A	

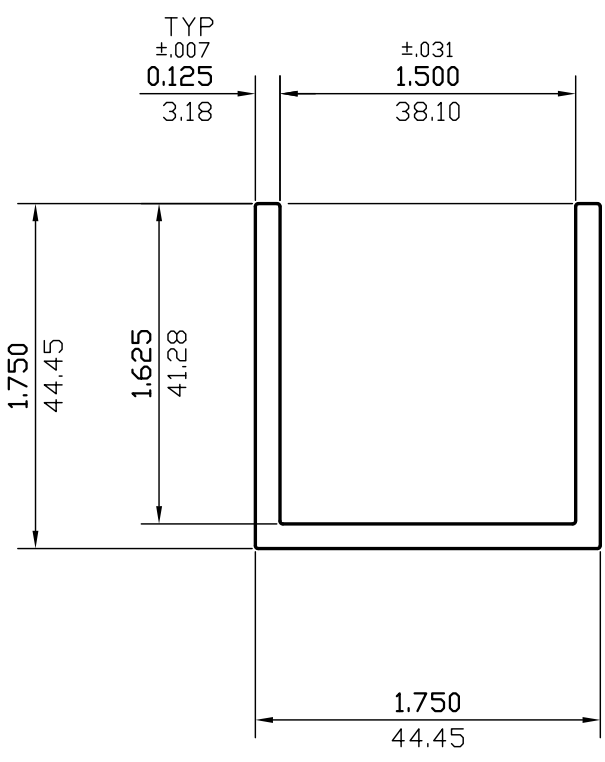

±.007  
WALL THICKNESS 0.125 (3.18) EXCEPT AS SHOWN

DATE	REV	DESCRIPTION	BY
EST.AREA	0.625	IN. <sup>2</sup>	EST.AREA 403.104
EST.WT.	0.737	LBS/FT.	EST.WT. 1.097
EST.PER.	10.198	IN.	EST.PER. 259.042
OUT PER.		IN.	OUT PER.
C.C.D.	2.462	IN.	C.C.D. 62.546
FINISH	M/F		ALLOY
CKD BY	FACTOR 14	SCALE 1:1	DWN BY P.M. DATE 09/25/2024

# CAN ART

85 PARKSHORE DRIVE  
BRAMPTON, ONT L6T 5M1  
TEL. NO. (905) 791-1464  
FAX NO. (905) 791-9151  
WEB: www.canart.com

**ALUMINUM EXTRUSION**

THIS DRAWING IS NOT NECESSARILY A COPY OF YOUR ORIGINAL. PLEASE APPROVE DIMENSIONS AND TOLERANCES INDICATED. CAN ART ASSUMES NO RESPONSIBILITY EITHER TECHNICAL OR LEGAL FOR HAVING THIS SHAPE MADE. THE CUSTOMER AGREES TO FULLY PROTECT CAN ART ALUMINUM FROM CLAIMS OF OTHERS RESULTING FROM THIS SHAPE.

SIGNED: \_\_\_\_\_ DATE: \_\_\_\_\_