

CUSTOMER PART No.	CUSTOMER	DIE No.
	CAN ART STD.	EH05707
DESCRIPTION		PROPOSAL No.
3" x 3" x 0.085" THICK SQ. TUBE		H-50042

NOTE: BREAK ALL CORNERS WITH 0.015" (.38 MM) RADIUS UNLESS OTHERWISE NOTED. STANDARD TOLERANCES TO APPLY UNLESS OTHERWISE SPECIFIED.

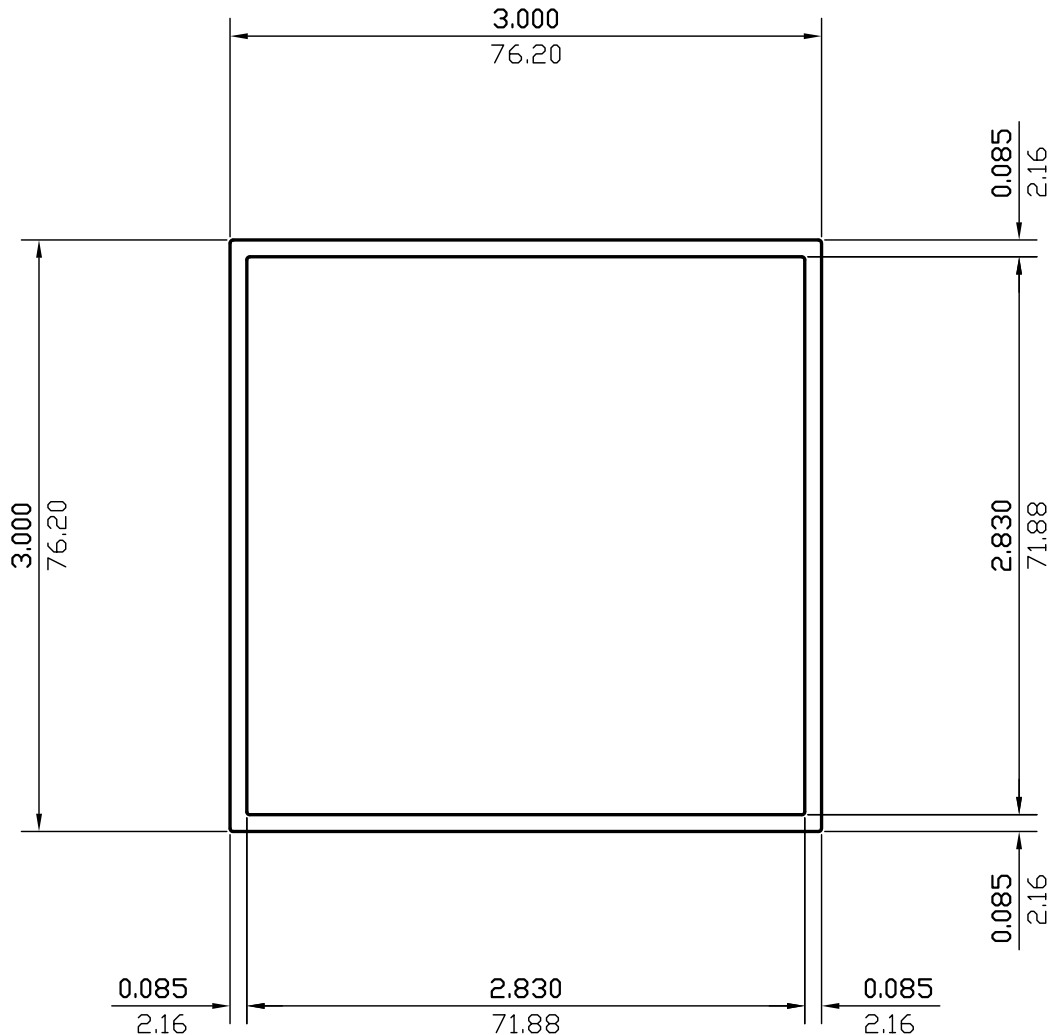

WALL THICKNESS 0.085 (2.16) EXCEPT AS SHOWN

DATE	REV	DESCRIPTION	BY
03/13/23	1	REMOVED ALLOY	JASON
EST.AREA	0.991	IN. ²	EST.AREA 639.423
			MM. ²
EST.WT.	1.169	LBS/FT.	EST.WT. 1.740
			KG/M.
EST.PER.	23.268	IN.	EST.PER. 591.020
			MM.
OUT PER.	11.974	IN.	OUT PER. 304.1
			MM.
C.C.D.	4.230	IN.	C.C.D. 107.447
			MM.
FACTOR	20	FINISH M/F	ALLOY & TEMP.
CKD BY	SCALE 1:1	DWN BY P.M.	DATE 05/19/2001

CAN ART

ALUMINUM EXTRUSION INC.

85 PARKSHORE DRIVE
BRAMPTON, ONT L6T 5M1
TEL. NO. (905) 791-1464
FAX NO. (905) 791-9151
E-MAIL: canart@canart.com

THIS DRAWING IS NOT NECESSARILY A COPY OF YOUR ORIGINAL. PLEASE APPROVE DIMENSIONS AND TOLERANCES INDICATED. CAN ART ASSUMES NO RESPONSIBILITY EITHER TECHNICAL OR LEGAL FOR HAVING THIS SHAPE MADE. THE CUSTOMER AGREES TO FULLY PROTECT CAN ART ALUMINUM FROM CLAIMS OF OTHERS RESULTING FROM THIS SHAPE.

SIGNED: _____ DATE: _____