

NOTE: BREAK ALL CORNERS WITH 0.015" (.38 MM) RADIUS UNLESS OTHERWISE NOTED. STANDARD TOLERANCES TO APPLY UNLESS OTHERWISE SPECIFIED.

CUSTOMER PART No.	CAN ART STD.	DIE No. ES05607
DESCRIPTION	3" x 1-1/2" x .375" CHANNEL	PROPOSAL No. S-7993

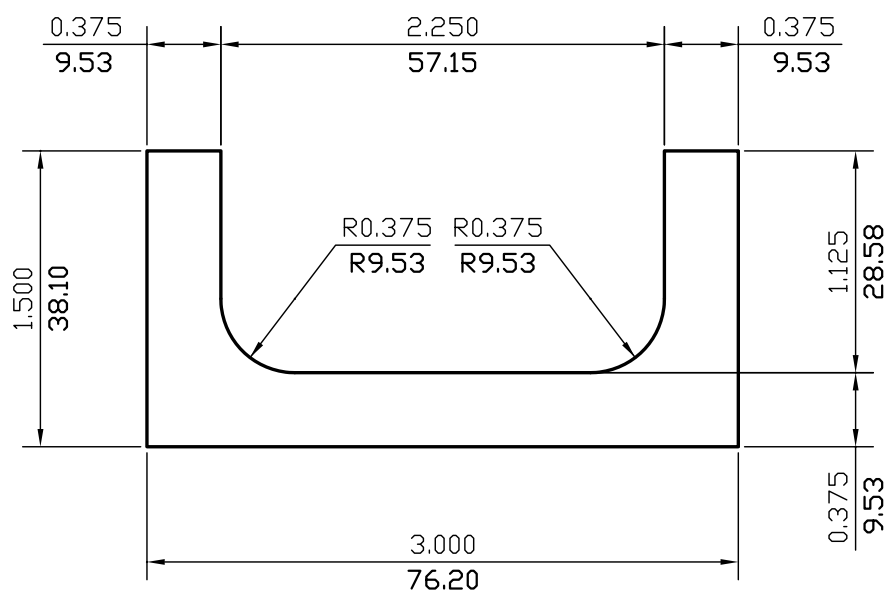

WALL THICKNESS **0.375 (9.53)** EXCEPT AS SHOWN

DATE	REV	DESCRIPTION	BY
03/21/23	2	REMOVED ALLDY	JASON
10/05/00	1	UPDATED DRAWING	P.M.
EST.AREA	2.029	IN. ²	EST.AREA 1309.109 MM. ²
EST.WT.	2.394	LBS/FT.	EST.WT. 3.563 KG/M.
EST.PER.	10.928	IN.	EST.PER. 277.574 MM.
OUT PER.		IN.	OUT PER. MM.
C.C.D.	3.354	IN.	C.C.D. 85.194 MM.
FACTOR 5	FINISH M/F	ALLOY & TEMP.	
CKD BY	SCALE 1:1	DWN BY C.P.	DATE 09/02/98

CAN ART

ALUMINUM EXTRUSION INC.

85 PARKSHORE DRIVE
BRAMPTON, ONT L6T 5M1
TEL. NO. (905) 791-1464
FAX NO. (905) 791-9151
E-MAIL: canart@canart.com

THIS DRAWING IS NOT NECESSARILY A COPY OF YOUR ORIGINAL. PLEASE APPROVE DIMENSIONS AND TOLERANCES INDICATED. CAN ART ASSUMES NO RESPONSIBILITY EITHER TECHNICAL OR LEGAL FOR HAVING THIS SHAPE MADE. THE CUSTOMER AGREES TO FULLY PROTECT CAN ART ALUMINUM FROM CLAIMS OF OTHERS RESULTING FROM THIS SHAPE.

SIGNED: _____ DATE: _____