

NOTE: BREAK ALL CORNERS WITH 0.015" (.38 MM) RADIUS UNLESS OTHERWISE NOTED. STANDARD TOLERANCES TO APPLY UNLESS OTHERWISE SPECIFIED.

CUSTOMER PART No.	CAN ART STD.	DIE No. ES05723
DESCRIPTION	3 x 1.41 x 0.170 WB CHANNEL	PROPOSAL No. S-50292

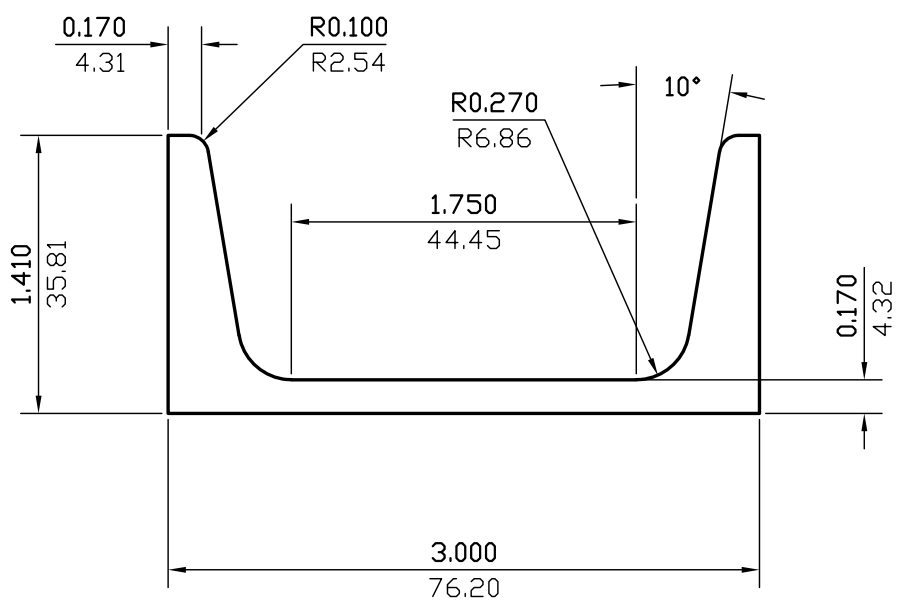

WALL THICKNESS (AS SHOWN) EXCEPT AS SHOWN

DATE	REV	DESCRIPTION	BY		
03/21/23	1	REMOVED ALLOY	JASON		
EST.AREA	1.255	IN. ²	EST.AREA	809.811	MM. ²
EST.WT.	1.506	LBS/FT.	EST.WT.	2.242	KG/M.
EST.PER.	10.705	IN.	EST.PER.	271.913	MM.
OUT PER.		IN.	OUT PER.		MM.
C.C.D.	3.315	IN.	C.C.D.	84.197	MM.
FACTOR	7	FINISH	M/F	ALLOY & TEMP.	
CHKD BY		SCALE	1:1	DWN BY	L.L.
				DATE	11/05/2001

CAN ART

ALUMINUM EXTRUSION INC.

428 JUTRAS DRIVE S.
WINDSOR, ONT. L6T 5M1
TEL. NO. (519) 727-4399
FAX NO. (519) 727-6434
E-MAIL: canart@canart.com

THIS DRAWING IS NOT NECESSARILY A COPY OF YOUR ORIGINAL. PLEASE APPROVE DIMENSIONS AND TOLERANCES INDICATED. CAN ART ASSUMES NO RESPONSIBILITY EITHER TECHNICAL OR LEGAL FOR HAVING THIS SHAPE MADE. THE CUSTOMER AGREES TO FULLY PROTECT CAN ART ALUMINUM FROM CLAIMS OF OTHERS RESULTING FROM THIS SHAPE.

SIGNED: _____ DATE: _____