

NOTE: BREAK ALL CORNERS WITH 0.015" (.38 MM) RADIUS UNLESS OTHERWISE NOTED. STANDARD TOLERANCES TO APPLY UNLESS OTHERWISE SPECIFIED.

CUSTOMER <b>CAN ART STD.</b>	DIE No. <b>ES05885</b>	REV. No. <b>1</b>
DESCRIPTION <b>1.00 x 4.00 FLAT BAR</b>	CUSTOMER PART No.	PROPOSAL No. <b>S-55615</b>

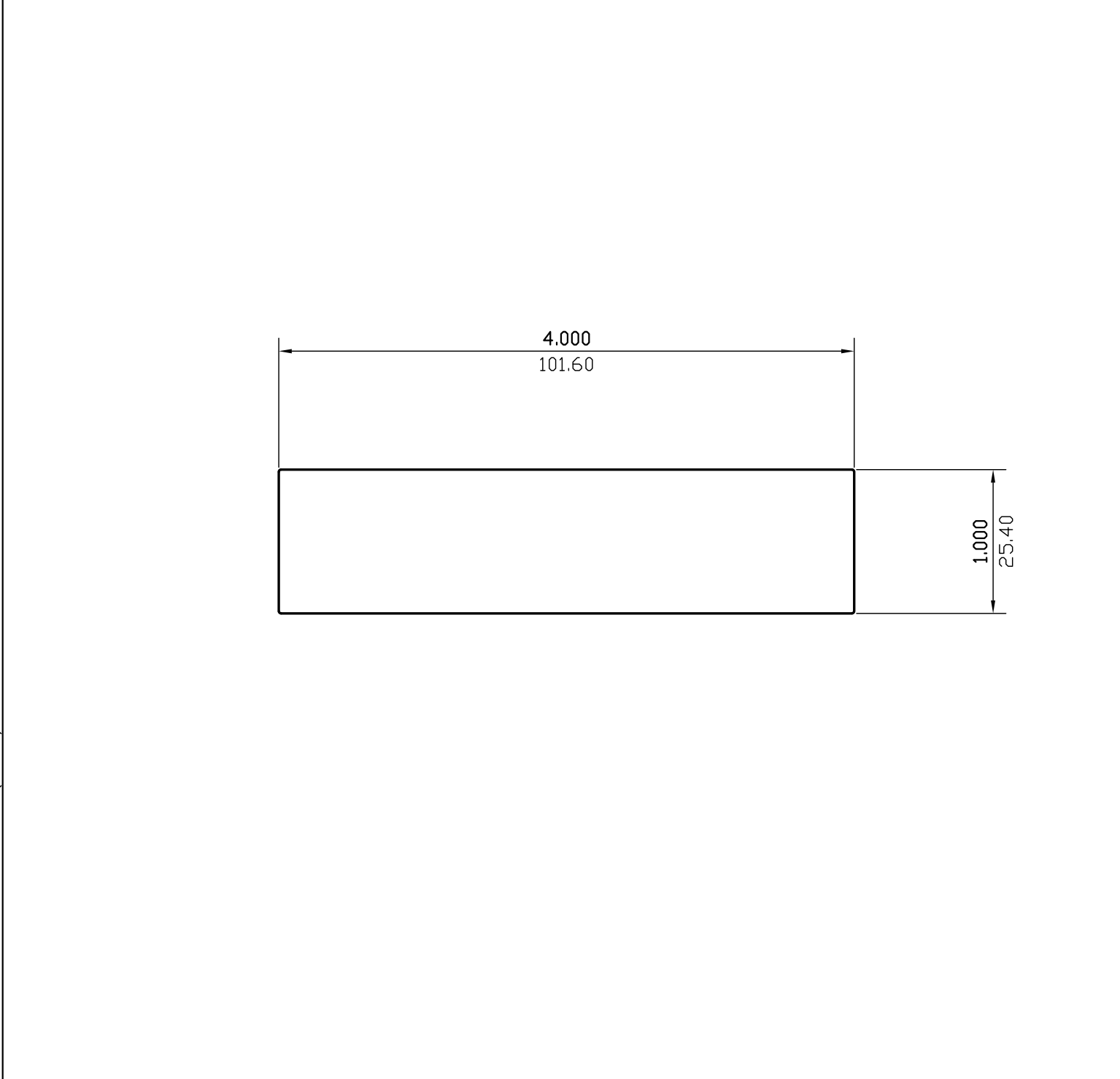

WALL THICKNESS (AS SHOWN) EXCEPT AS SHOWN

DATE	REV	DESCRIPTION	BY
03/17/23	1	REMOVED ALLOY	JASON
EST.AREA	4.000	IN. <sup>2</sup>	EST.AREA 2580.536
			MM. <sup>2</sup>
EST.WT.	4.800	LBS/FT.	EST.WT. 7.143
			KG/M.
EST.PER.	9.974	IN.	EST.PER. 253.346
			MM.
OUT PER.		IN.	OUT PER.
			MM.
C.C.D.	4.116	IN.	C.C.D. 104.545
			MM.
FINISH	M/F		ALLOY
CKD BY	FACTOR 2	SCALE 1:1	DWN BY L.G. DATE 05/22/2008

# CAN ART

ALUMINUM EXTRUSION INC.

428 JUTRAS DRIVE S.  
WINDSOR, ON N8N 5C5  
TEL. NO. (519) 727-4399  
FAX NO. (519) 727-6434  
WEB: www.canart.com

THIS DRAWING IS NOT NECESSARILY A COPY OF YOUR ORIGINAL. PLEASE APPROVE DIMENSIONS AND TOLERANCES INDICATED. CAN ART ASSUMES NO RESPONSIBILITY EITHER TECHNICAL OR LEGAL FOR HAVING THIS SHAPE MADE. THE CUSTOMER AGREES TO FULLY PROTECT CAN ART ALUMINUM FROM CLAIMS OF OTHERS RESULTING FROM THIS SHAPE.

SIGNED: \_\_\_\_\_ DATE: \_\_\_\_\_