

NOTE: BREAK ALL CORNERS WITH 0.015" (.38 MM) RADIUS UNLESS OTHERWISE NOTED. STANDARD TOLERANCES TO APPLY UNLESS OTHERWISE SPECIFIED.

CUSTOMER PART No.	CAN ART STD.	DIE No. ES05741
DESCRIPTION	2" x 3/4" THK. FLAT BAR	PROPOSAL No. S-50482

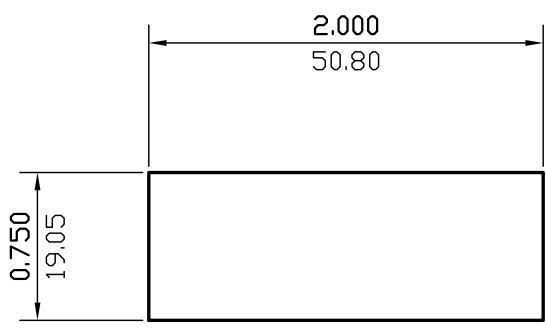

WALL THICKNESS (AS SHOWN) EXCEPT AS SHOWN

DATE	REV	DESCRIPTION	BY
03/17/23	1	REMOVED EXPOSED SURFACES AND ALLOY	JASON
EST.AREA		1.500 IN. ²	EST.AREA 967.748 MM. ²
EST.WT.		1.800 LBS/FT.	EST.WT. 2.679 KG/M.
EST.PER.		5.500 IN.	EST.PER. 139.700 MM.
OUT PER.		IN.	OUT PER. MM.
C.C.D.		2.136 IN.	C.C.D. 54.254 MM.
FACTOR	3	FINISH M/F	ALLOY & TEMP.
CKD BY	SCALE 1:1	DWN BY L.L.	DATE 01/16/2002

CAN ART

ALUMINUM EXTRUSION INC.

428 JUTRAS DRIVE S.
 WINDSOR, ONT. N8N 5C5
 TEL. NO. (519) 727-4399
 FAX NO. (519) 727-6434
 E-MAIL: canart@canart.com

THIS DRAWING IS NOT NECESSARILY A COPY OF YOUR ORIGINAL. PLEASE APPROVE DIMENSIONS AND TOLERANCES INDICATED. CAN ART ASSUMES NO RESPONSIBILITY EITHER TECHNICAL OR LEGAL FOR HAVING THIS SHAPE MADE. THE CUSTOMER AGREES TO FULLY PROTECT CAN ART ALUMINUM FROM CLAIMS OF OTHERS RESULTING FROM THIS SHAPE.

SIGNED: _____ DATE: _____