

NOTE: BREAK ALL CORNERS WITH 0.015" (.38 MM) RADIUS UNLESS OTHERWISE NOTED. STANDARD TOLERANCES TO APPLY UNLESS OTHERWISE SPECIFIED.

CUSTOMER CAN ART STD.		DIE No. ES05917	REV. No. 1
DESCRIPTION 3/4" x 1-3/4" RECT. BAR	CUSTOMER PART No.	QUOTE No. 08-1007-1	PROPOSAL No. S-20041

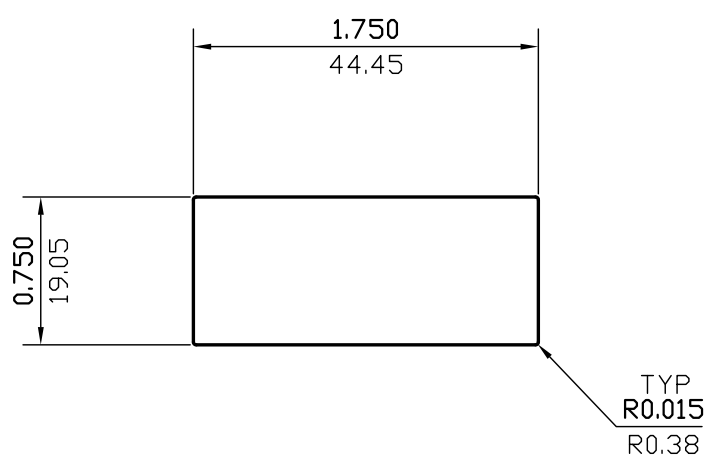

WALL THICKNESS (AS SHOWN) EXCEPT AS SHOWN

DATE	REV	DESCRIPTION	BY					
03/17/23	1	REMOVED ALLOY	JASON					
EST.AREA	1.312	IN. ²	EST.AREA	846.655	MM. ²			
EST.WT.	1.575	LBS/FT.	EST.WT.	2.344	KG/M.			
EST.PER.	4.974	IN.	EST.PER.	126.346	MM.			
OUT PER.		IN.	OUT PER.		MM.			
C.C.D.	1.892	IN.	C.C.D.	48.067	MM.			
FINISH	M/F		ALLOY					
CKD BY	FACTOR	3	SCALE	1:1	DWN BY	P.M.	DATE	11/28/2008

CAN ART

85 PARKSHORE DRIVE
BRAMPTON, ONT L6T 5M1
TEL. NO. (905) 791-1464
FAX NO. (905) 791-9151
WEB: www.canart.com

ALUMINUM EXTRUSION INC.

THIS DRAWING IS NOT NECESSARILY A COPY OF YOUR ORIGINAL. PLEASE APPROVE DIMENSIONS AND TOLERANCES INDICATED. CAN ART ASSUMES NO RESPONSIBILITY EITHER TECHNICAL OR LEGAL FOR HAVING THIS SHAPE MADE. THE CUSTOMER AGREES TO FULLY PROTECT CAN ART ALUMINUM FROM CLAIMS OF OTHERS RESULTING FROM THIS SHAPE.

SIGNED: _____ DATE: _____