

NOTE: BREAK ALL CORNERS WITH 0.015" (.38 MM) RADIUS UNLESS OTHERWISE NOTED. STANDARD TOLERANCES TO APPLY UNLESS OTHERWISE SPECIFIED.

CUSTOMER PART No.	<b>CAN ART STD.</b>	DIE No. <b>ES05549</b>
DESCRIPTION	1" x 3/4" FLAT BAR	PROPOSAL No. <b>S-6391</b>

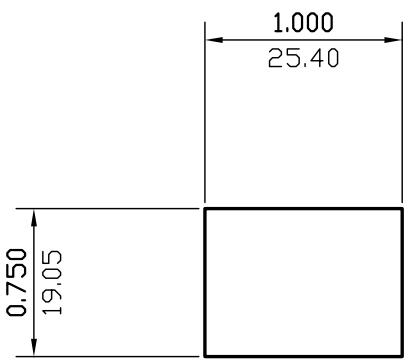

NOTE:  
FULL WATER QUENCH

WALL THICKNESS (AS SHOWN) EXCEPT AS SHOWN

DATE	REV	DESCRIPTION	BY
03/17/23	2	REMOVED ALLOY	JASON
08/17/99	1	REDRAWN	P.M.
EST.AREA	0.750	IN. <sup>2</sup>	EST.AREA 484
			MM. <sup>2</sup>
EST.WT.	0.885	LBS/FT.	EST.WT. 1.317
			KG/M.
EST.PER.	3.500	IN.	EST.PER. 88.9
			MM.
OUT PER.		IN.	OUT PER.
			MM.
C.C.D.	1.250	IN.	C.C.D. 32
			MM.
FACTOR	4	FINISH	M/F
		ALLOY & TEMP.	
CKD BY	SCALE	1:1	DWN BY C.P. DATE 04/30/97

# CAN ART

ALUMINUM EXTRUSION INC.

85 PARKSHORE DRIVE  
BRAMPTON, ONT L6T 5M1  
TEL. NO. (905) 791-1464  
FAX NO. (905) 791-9151  
E-MAIL: canart@canart.com

THIS DRAWING IS NOT NECESSARILY A COPY OF YOUR ORIGINAL. PLEASE APPROVE DIMENSIONS AND TOLERANCES INDICATED. CAN ART ASSUMES NO RESPONSIBILITY EITHER TECHNICAL OR LEGAL FOR HAVING THIS SHAPE MADE. THE CUSTOMER AGREES TO FULLY PROTECT CAN ART ALUMINUM FROM CLAIMS OF OTHERS RESULTING FROM THIS SHAPE.

SIGNED: \_\_\_\_\_ DATE: \_\_\_\_\_