

NOTE: BREAK ALL CORNERS WITH 0.015" (.38 MM) RADIUS UNLESS OTHERWISE NOTED. STANDARD TOLERANCES TO APPLY UNLESS OTHERWISE SPECIFIED.

CUSTOMER PART No.	CUSTOMER <b>CAN ART STD.</b>	DIE No. <b>ES05507</b>
DESCRIPTION <b>2 1/2" x 3/8" THK. FLAT BAR</b>		PROPOSAL No. <b>S-5163</b>

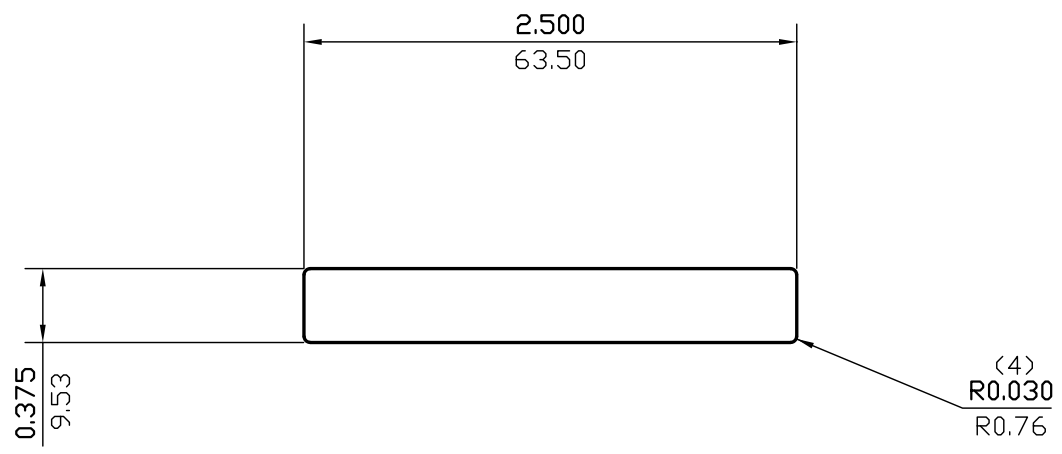

WALL THICKNESS (AS SHOWN) EXCEPT AS SHOWN

DATE	REV	DESCRIPTION	BY		
03/17/23	2	REMOVED ALLOY	JASON		
08/13/99	1	REDRAWN	P.M.		
EST.AREA	0.937	IN. <sup>2</sup>	EST.AREA	604	MM. <sup>2</sup>
EST.WT.	1.105	LBS/FT.	EST.WT.	1.645	KG/M.
EST.PER.	5.698	IN.	EST.PER.	144.7	MM.
OUT PER.		IN.	OUT PER.		MM.
C.C.D.	2.520	IN.	C.C.D.	64	MM.
FACTOR	5	FINISH	M/F	ALLOY & TEMP.	
CKD BY		SCALE	1:1	DWN BY	C.P. DATE 02/21/96

# CAN ART

85 PARKSHORE DRIVE  
BRAMPTON, ONT L6T 5M1  
TEL. NO. (905) 791-1464  
FAX NO. (905) 791-9151  
E-MAIL: canart@canart.com

ALUMINUM EXTRUSION INC.

THIS DRAWING IS NOT NECESSARILY A COPY OF YOUR ORIGINAL. PLEASE APPROVE DIMENSIONS AND TOLERANCES INDICATED. CAN ART ASSUMES NO RESPONSIBILITY EITHER TECHNICAL OR LEGAL FOR HAVING THIS SHAPE MADE. THE CUSTOMER AGREES TO FULLY PROTECT CAN ART ALUMINUM FROM CLAIMS OF OTHERS RESULTING FROM THIS SHAPE.

SIGNED: \_\_\_\_\_ DATE: \_\_\_\_\_