

NOTE: BREAK ALL CORNERS WITH 0.015" (.38 MM) RADIUS UNLESS OTHERWISE NOTED. STANDARD TOLERANCES TO APPLY UNLESS OTHERWISE SPECIFIED.

CUSTOMER CAN ART STD.		DIE No. ES04026	REV. No. 1
DESCRIPTION 0.625" x 1.500" RECT. BAR	CUSTOMER PART No.	QUOTE No. 14-0446-2	PROPOSAL No. S-29956

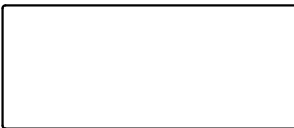
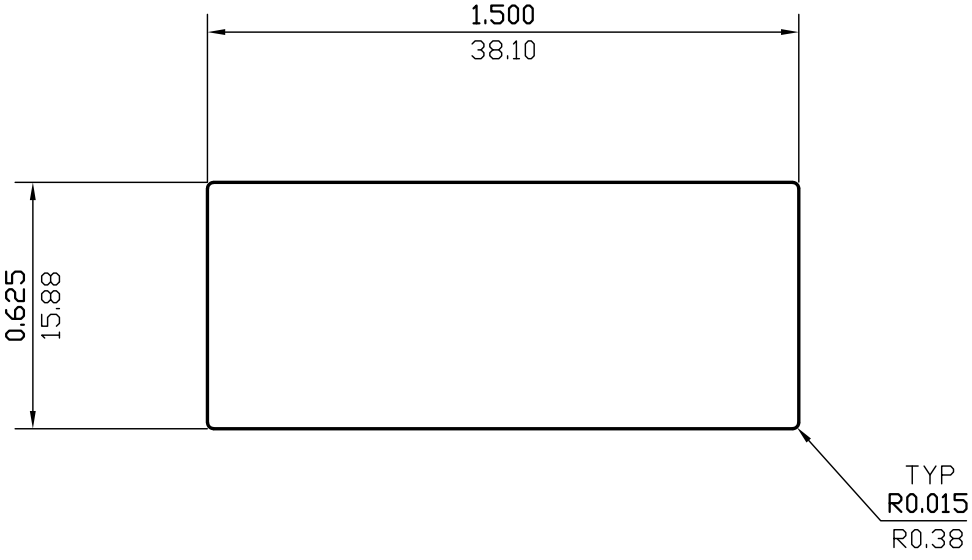

ACTUAL SIZE

WALL THICKNESS (AS SHOWN) EXCEPT AS SHOWN

DATE	REV	DESCRIPTION	BY
03/17/23	1	REMOVED EXPOSED SURFACES AND ALLOY	JASON
EST.AREA		0.937 IN. ²	EST.AREA 604.718 MM. ²
EST.WT.		1.106 LBS/FT.	EST.WT. 1.646 KG/M.
EST.PER.		4.224 IN.	EST.PER. 107.296 MM.
OUT PER.		IN.	OUT PER. MM.
C.C.D.		1.614 IN.	C.C.D. 40.988 MM.
FINISH		M/F	ALLOY
CKD BY	FACTOR 4	SCALE 2:1	DWN BY P.M. DATE 04/29/2014

CAN ART

85 PARKSHORE DRIVE
BRAMPTON, ONT L6T 5M1
TEL. NO. (905) 791-1464
FAX NO. (905) 791-9151
WEB: www.canart.com

ALUMINUM EXTRUSION INC.

THIS DRAWING IS NOT NECESSARILY A COPY OF YOUR ORIGINAL. PLEASE APPROVE DIMENSIONS AND TOLERANCES INDICATED. CAN ART ASSUMES NO RESPONSIBILITY EITHER TECHNICAL OR LEGAL FOR HAVING THIS SHAPE MADE. THE CUSTOMER AGREES TO FULLY PROTECT CAN ART ALUMINUM FROM CLAIMS OF OTHERS RESULTING FROM THIS SHAPE.

SIGNED: _____ DATE: _____