

NOTE: BREAK ALL CORNERS WITH 0.015" (.38 MM) RADIUS UNLESS OTHERWISE NOTED. STANDARD TOLERANCES TO APPLY UNLESS OTHERWISE SPECIFIED.

CUSTOMER PART No.	CUSTOMER <b>CAN ART STD.</b>	DIE No. <b>ES05559</b>
DESCRIPTION <b>5" x 1/2" THK. FLAT BAR</b>	PROPOSAL No. <b>S-6445</b>	

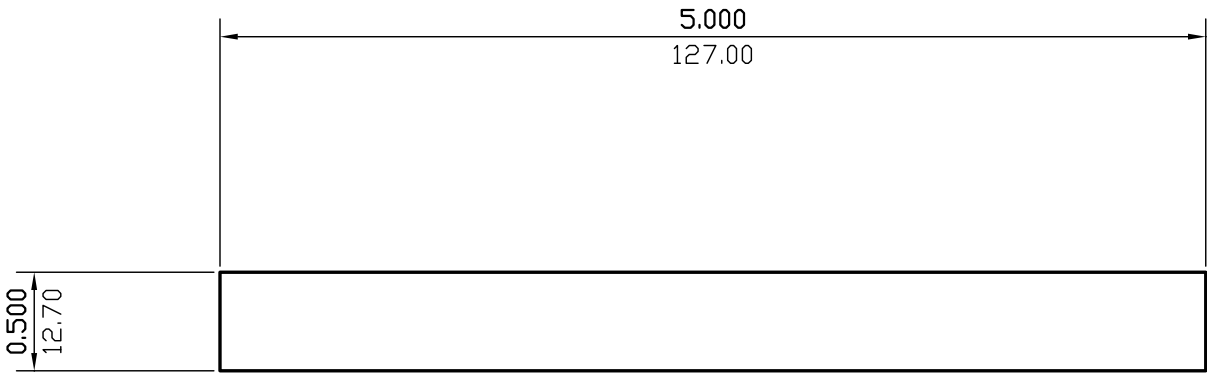

**NOTE:**  
**FULL WATER QUENCH**

WALL THICKNESS (AS SHOWN) EXCEPT AS SHOWN

DATE	REV	DESCRIPTION	BY
03/17/23	2	REMOVED ALLOY	JASON
08/20/99	1	REDRAWN	P.M.

EST.AREA	2.500	IN. <sup>2</sup>	EST.AREA	1613	MM. <sup>2</sup>
EST.WT.	2.950	LBS/FT.	EST.WT.	4.390	KG/M.
EST.PER.	11.000	IN.	EST.PER.	279.4	MM.
OUT PER.		IN.	OUT PER.		MM.
C.C.D.	5.025	IN.	C.C.D.	128	MM.
FACTOR	4	FINISH	M/F	ALLOY & TEMP.	
CKD BY		SCALE	1:1	DWN BY	C.P. DATE 05/13/97

**CAN ART**

85 PARKSHORE DRIVE  
BRAMPTON, ONT L6T 5M1  
TEL. NO. (905) 791-1464  
FAX NO. (905) 791-9151  
E-MAIL: canart@canart.com

ALUMINUM EXTRUSION INC.

THIS DRAWING IS NOT NECESSARILY A COPY OF YOUR ORIGINAL. PLEASE APPROVE DIMENSIONS AND TOLERANCES INDICATED. CAN ART ASSUMES NO RESPONSIBILITY EITHER TECHNICAL OR LEGAL FOR HAVING THIS SHAPE MADE. THE CUSTOMER AGREES TO FULLY PROTECT CAN ART ALUMINUM FROM CLAIMS OF OTHERS RESULTING FROM THIS SHAPE.

SIGNED: \_\_\_\_\_ DATE: \_\_\_\_\_