

NOTE: BREAK ALL CORNERS WITH 0.015" (.38 MM) RADIUS UNLESS OTHERWISE NOTED. STANDARD TOLERANCES TO APPLY UNLESS OTHERWISE SPECIFIED.

CUSTOMER PART No.	CAN ART STD.	DIE No. ES05583
DESCRIPTION	4" x 1/2" THK. FLAT BAR	PROPOSAL No. S-6944

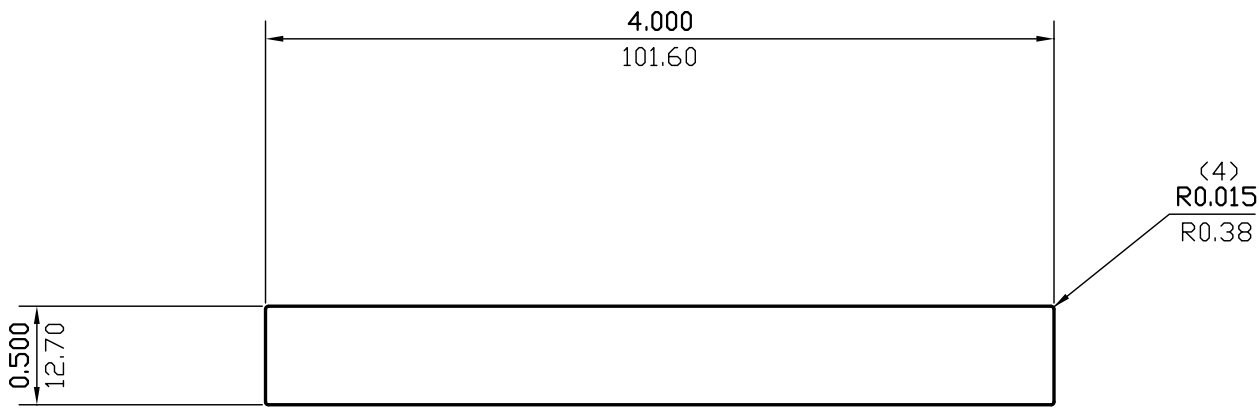

WALL THICKNESS 0.500 (12.70) EXCEPT AS SHOWN

DATE	REV	DESCRIPTION	BY
03/17/23	2	REMOVED ALLOY	JASON
08/20/99	1	REDRAWN	P.M.

EST.AREA	2.000	IN. ²	EST.AREA	1290	MM. ²
EST.WT.	2.360	LBS/FT.	EST.WT.	3.512	KG/M.
EST.PER.	8.974	IN.	EST.PER.	227.9	MM.
OUT PER.		IN.	OUT PER.		MM.
C.C.D.	4.028	IN.	C.C.D.	102	MM.
FACTOR	4	FINISH	M/F	ALLOY & TEMP.	
CKD BY		SCALE	1:1	DWN BY	C.P. DATE 10/03/97

CAN ART

ALUMINUM EXTRUSION INC.

85 PARKSHORE DRIVE
BRAMPTON, ONT L6T 5M1
TEL. NO. (905) 791-1464
FAX NO. (905) 791-9151
E-MAIL: canart@canart.com

THIS DRAWING IS NOT NECESSARILY A COPY OF YOUR ORIGINAL. PLEASE APPROVE DIMENSIONS AND TOLERANCES INDICATED. CAN ART ASSUMES NO RESPONSIBILITY EITHER TECHNICAL OR LEGAL FOR HAVING THIS SHAPE MADE. THE CUSTOMER AGREES TO FULLY PROTECT CAN ART ALUMINUM FROM CLAIMS OF OTHERS RESULTING FROM THIS SHAPE.

SIGNED: _____ DATE: _____