

NOTE: BREAK ALL CORNERS WITH 0.015" (.38 MM) RADIUS UNLESS OTHERWISE NOTED. STANDARD TOLERANCES TO APPLY UNLESS OTHERWISE SPECIFIED.

CUSTOMER PART No.	<b>CAN ART STD.</b>	DIE No. <b>ES05777</b>
DESCRIPTION	1-1/2" x 1/2" BAR STOCK	PROPOSAL No. S-51100

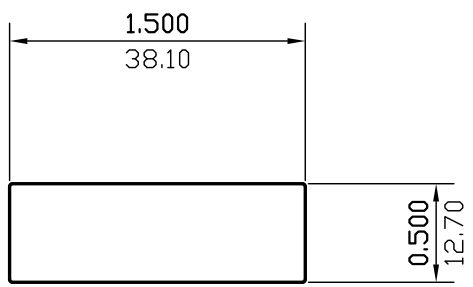

WALL THICKNESS (AS SHOWN) EXCEPT AS SHOWN

DATE	REV	DESCRIPTION	BY
03/17/23	1	REMOVED EXPOSED SURFACES AND ALLOY	JASON
EST.AREA	0.750	IN. <sup>2</sup>	EST.AREA 483.749
			MM. <sup>2</sup>
EST.WT.	0.900	LBS/FT.	EST.WT. 1.339
			KG/M.
EST.PER.	3.974	IN.	EST.PER. 100.946
			MM.
OUT PER.		IN.	OUT PER.
			MM.
C.C.D.	1.570	IN.	C.C.D. 39.879
			MM.
FACTOR	4	FINISH ANOD.	ALLOY & TEMP.
CKD BY	SCALE 1:1	DWN BY L.G.	DATE 12/17/2002

# CAN ART

ALUMINUM EXTRUSION INC.

428 JUTRAS DRIVE S.  
WINDSOR, ONT. N8N 5C5  
TEL. NO. (519) 727-4399  
FAX NO. (519) 727-6434  
E-MAIL: canart@canart.com

THIS DRAWING IS NOT NECESSARILY A COPY OF YOUR ORIGINAL. PLEASE APPROVE DIMENSIONS AND TOLERANCES INDICATED. CAN ART ASSUMES NO RESPONSIBILITY EITHER TECHNICAL OR LEGAL FOR HAVING THIS SHAPE MADE. THE CUSTOMER AGREES TO FULLY PROTECT CAN ART ALUMINUM FROM CLAIMS OF OTHERS RESULTING FROM THIS SHAPE.

SIGNED: \_\_\_\_\_ DATE: \_\_\_\_\_