

CUSTOMER PART No.	CUSTOMER <b>CAN ART STD.</b>	DIE No. <b>ES08615</b>
DESCRIPTION	<b>1" x 1/2" THK. FLAT BAR</b>	PROPOSAL No. <b>S-5197</b>

NOTE: BREAK ALL CORNERS WITH 0.015" (.38 MM) RADIUS UNLESS OTHERWISE NOTED. STANDARD TOLERANCES TO APPLY UNLESS OTHERWISE SPECIFIED.

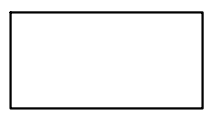
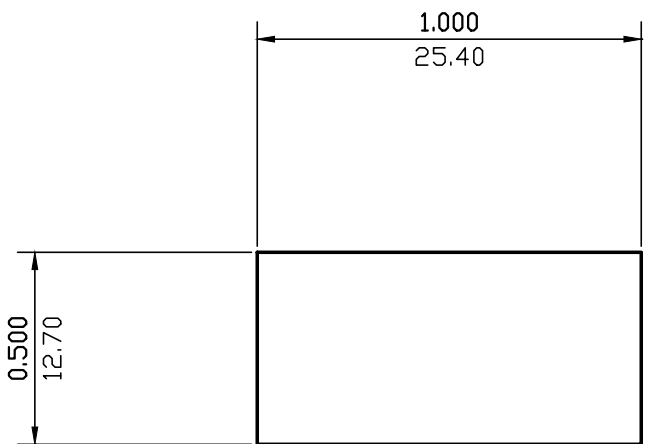

ACTUAL SIZE

WALL THICKNESS (AS SHOWN) EXCEPT AS SHOWN

DATE	REV	DESCRIPTION	BY
EST.AREA	0.500	IN. <sup>2</sup>	EST.AREA 323
EST.WT.	0.590	LBS./FT.	EST.WT. 0.878
EST.PER.	3.000	IN.	EST.PER. 76.2
OUT PER.		IN.	OUT PER.
C.C.D.	1.118	IN.	C.C.D. 28
FACTOR	5	FINISH M/F	ALLOY & TEMP. 6061
CKD BY	SCALE 2:1	DWN BY C.P.	DATE 03/04/96

**CAN ART**

85 PARKSHORE DRIVE  
BRAMPTON, ONT L6T 5M1  
TEL. NO. (905) 791-1464  
FAX NO. (905) 791-9151  
E-MAIL: canart@canart.com

ALUMINUM EXTRUSION INC.

THIS DRAWING IS NOT NECESSARILY A COPY OF YOUR ORIGINAL. PLEASE APPROVE DIMENSIONS AND TOLERANCES INDICATED. CAN ART ASSUMES NO RESPONSIBILITY EITHER TECHNICAL OR LEGAL FOR HAVING THIS SHAPE MADE. THE CUSTOMER AGREES TO FULLY PROTECT CAN ART ALUMINUM FROM CLAIMS OF OTHERS RESULTING FROM THIS SHAPE.

SIGNED: \_\_\_\_\_ DATE: \_\_\_\_\_