

NOTE: BREAK ALL CORNERS WITH 0.015" (.38 MM) RADIUS UNLESS OTHERWISE NOTED. STANDARD TOLERANCES TO APPLY UNLESS OTHERWISE SPECIFIED.

CUSTOMER PART No.	<b>CAN ART STD.</b>	DIE No. <b>ES05610</b>
DESCRIPTION	5" x .375" FLAT BAR	PROPOSAL No. <b>S-7994</b>

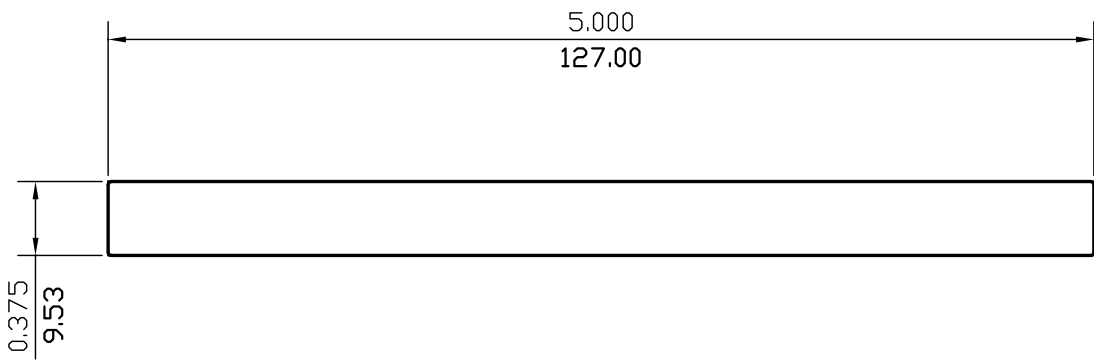

WALL THICKNESS **0.375 (9.53)** EXCEPT AS SHOWN

DATE	REV	DESCRIPTION	BY
03/17/23	2	REMOVED ALLOY	JASON
10/05/00	1	UPDATED DRAWING	P.M.
EST.AREA	1.875	IN. <sup>2</sup>	EST.AREA 1209.685
			MM. <sup>2</sup>
EST.WT.	2.213	LBS/FT.	EST.WT. 3.293
			KG/M.
EST.PER.	10.750	IN.	EST.PER. 273.050
			MM.
OUT PER.		IN.	OUT PER.
			MM.
C.C.D.	5.014	IN.	C.C.D. 127.357
			MM.
FACTOR	5	FINISH	M/F
		ALLOY & TEMP.	
CKD BY	SCALE	1:1	DWN BY C.P. DATE 09/02/98

# CAN ART

ALUMINUM EXTRUSION INC.

85 PARKSHORE DRIVE  
BRAMPTON, ONT L6T 5M1  
TEL. NO. (905) 791-1464  
FAX NO. (905) 791-9151  
E-MAIL: canart@canart.com

THIS DRAWING IS NOT NECESSARILY A COPY OF YOUR ORIGINAL. PLEASE APPROVE DIMENSIONS AND TOLERANCES INDICATED. CAN ART ASSUMES NO RESPONSIBILITY EITHER TECHNICAL OR LEGAL FOR HAVING THIS SHAPE MADE. THE CUSTOMER AGREES TO FULLY PROTECT CAN ART ALUMINUM FROM CLAIMS OF OTHERS RESULTING FROM THIS SHAPE.

SIGNED: \_\_\_\_\_ DATE: \_\_\_\_\_