

NOTE: BREAK ALL CORNERS WITH 0.015" (.38 MM) RADIUS UNLESS OTHERWISE NOTED. STANDARD TOLERANCES TO APPLY UNLESS OTHERWISE SPECIFIED.

CUSTOMER PART No.	<b>CAN ART STD.</b>	DIE No. <b>ES05692</b>
DESCRIPTION	2-1/2 x 3/8 S.C. FLAT BAR	PROPOSAL No. S-10660

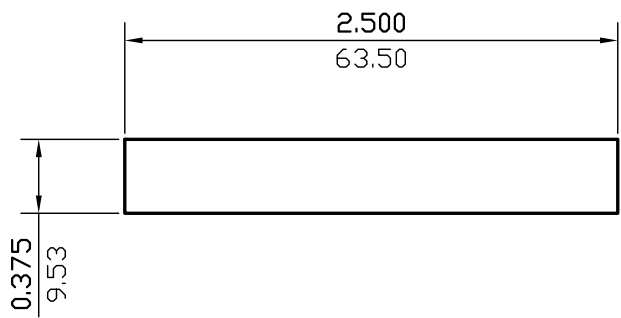

WALL THICKNESS (AS SHOWN) EXCEPT AS SHOWN

DATE	REV	DESCRIPTION	BY
03/17/23	1	REMOVED ALLOY	JASON
EST.AREA	0.937	IN. <sup>2</sup>	EST.AREA 604.842
			MM. <sup>2</sup>
EST.WT.	1.106	LBS/FT.	EST.WT. 1.646
			KG/M.
EST.PER.	5.750	IN.	EST.PER. 146.050
			MM.
OUT PER.		IN.	OUT PER.
			MM.
C.C.D.	2.528	IN.	C.C.D. 64.210
			MM.
FACTOR	5	FINISH	M/F
		ALLOY & TEMP.	
CKD BY	SCALE 1:1	DWN BY	C.P. DATE 01/15/2001

# CAN ART

ALUMINUM EXTRUSION INC.

85 PARKSHORE DRIVE  
 BRAMPTON, ONT L6T 5M1  
 TEL. NO. (905) 791-1464  
 FAX NO. (905) 791-9151  
 E-MAIL: canart@canart.com

THIS DRAWING IS NOT NECESSARILY A COPY OF YOUR ORIGINAL. PLEASE APPROVE DIMENSIONS AND TOLERANCES INDICATED. CAN ART ASSUMES NO RESPONSIBILITY EITHER TECHNICAL OR LEGAL FOR HAVING THIS SHAPE MADE. THE CUSTOMER AGREES TO FULLY PROTECT CAN ART ALUMINUM FROM CLAIMS OF OTHERS RESULTING FROM THIS SHAPE.

SIGNED: \_\_\_\_\_ DATE: \_\_\_\_\_