

NOTE: BREAK ALL CORNERS WITH 0.015" (.38 MM) RADIUS UNLESS OTHERWISE NOTED. STANDARD TOLERANCES TO APPLY UNLESS OTHERWISE SPECIFIED.

CUSTOMER PART No.	CUSTOMER CAN ART STD.	DIE No. ES05691
DESCRIPTION	1 x 3/8 S.C. FLAT BAR	PROPOSAL No. S-10659

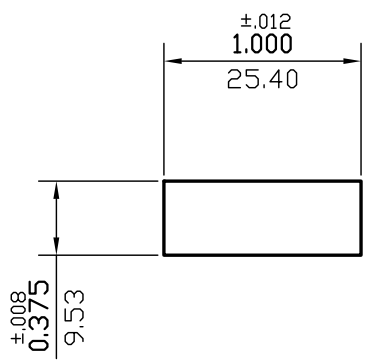

WALL THICKNESS (AS SHOWN) EXCEPT AS SHOWN

DATE	REV	DESCRIPTION	BY
03/17/23	1	REMOVED ALLOY	JASON
EST.AREA	0.375	IN. ²	EST.AREA 241.937
			MM. ²
EST.WT.	0.443	LBS/FT.	EST.WT. 0.659
			KG/M.
EST.PER.	2.750	IN.	EST.PER. 69.850
			MM.
OUT PER.		IN.	OUT PER.
			MM.
C.C.D.	1.068	IN.	C.C.D. 27.127
			MM.
FACTOR	6	FINISH	M/F
		ALLOY & TEMP.	
CKD BY	SCALE 1:1	DWN BY	C.P. DATE 01/15/2001

CAN ART
ALUMINUM EXTRUSION INC.

85 PARKSHORE DRIVE
BRAMPTON, ONT L6T 5M1
TEL. NO. (905) 791-1464
FAX NO. (905) 791-9151
E-MAIL: canart@canart.com

THIS DRAWING IS NOT NECESSARILY A COPY OF YOUR ORIGINAL. PLEASE APPROVE DIMENSIONS AND TOLERANCES INDICATED. CAN ART ASSUMES NO RESPONSIBILITY EITHER TECHNICAL OR LEGAL FOR HAVING THIS SHAPE MADE. THE CUSTOMER AGREES TO FULLY PROTECT CAN ART ALUMINUM FROM CLAIMS OF OTHERS RESULTING FROM THIS SHAPE.

SIGNED: _____ DATE: _____