

NOTE: BREAK ALL CORNERS WITH 0.015" (.38 MM) RADIUS UNLESS OTHERWISE NOTED. STANDARD TOLERANCES TO APPLY UNLESS OTHERWISE SPECIFIED.

CUSTOMER PART No.	CUSTOMER CAN ART STD.	DIE No. ES05445
DESCRIPTION 1/2" x 5/16" FLAT BAR	PROPOSAL No. S-3713	

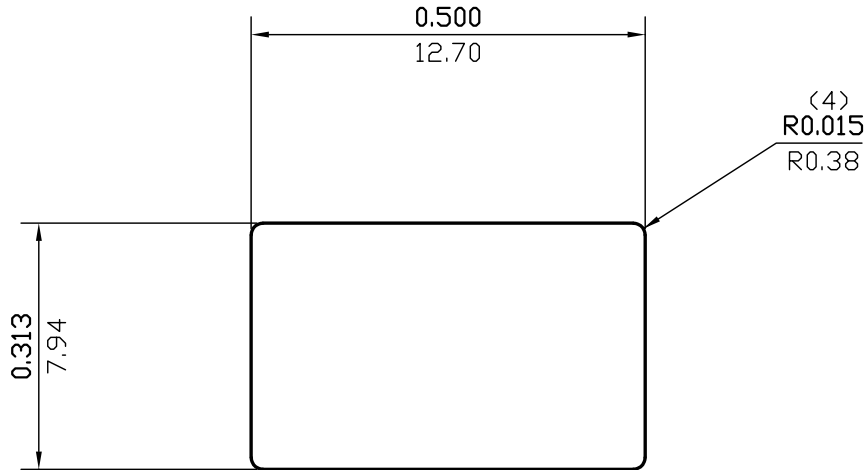

 ACTUAL SIZE

WALL THICKNESS (AS SHOWN) EXCEPT AS SHOWN

DATE	REV	DESCRIPTION	BY
03/17/23	3	REMOVED ALLOY	JASON
10-10-02	2	ACTUAL SIZE REVISED.	TIND'
EST.AREA	0.156	IN. ²	EST.AREA 101
			MM. ²
EST.WT.	0.184	LBS/FT.	EST.WT. 0.274
			KG/M.
EST.PER.	1.599	IN.	EST.PER. 40.6
			MM.
OUT PER.		IN.	OUT PER.
			MM.
C.C.D.	0.579	IN.	C.C.D. 15
			MM.
FACTOR 9	FINISH M/F	ALLOY & TEMP.	
CKD BY	SCALE 4:1	DWN BY C.P.	DATE 04/28/94

CAN ART

ALUMINUM EXTRUSION INC.

85 PARKSHORE DRIVE
BRAMPTON, ONT L6T 5M1
TEL. NO. (905) 791-1464
FAX NO. (905) 791-9151
E-MAIL: canart@canart.com

THIS DRAWING IS NOT NECESSARILY A COPY OF YOUR ORIGINAL. PLEASE APPROVE DIMENSIONS AND TOLERANCES INDICATED. CAN ART ASSUMES NO RESPONSIBILITY EITHER TECHNICAL OR LEGAL FOR HAVING THIS SHAPE MADE. THE CUSTOMER AGREES TO FULLY PROTECT CAN ART ALUMINUM FROM CLAIMS OF OTHERS RESULTING FROM THIS SHAPE.

SIGNED: _____ DATE: _____