

NOTE: BREAK ALL CORNERS WITH 0.015" (.38 MM) RADIUS UNLESS OTHERWISE NOTED. STANDARD TOLERANCES TO APPLY UNLESS OTHERWISE SPECIFIED.

CUSTOMER PART No.	CUSTOMER CAN ART STD.	DIE No. ES05497
DESCRIPTION 4" x 0.250" THK. FLAT BAR		PROPOSAL No. S-4932

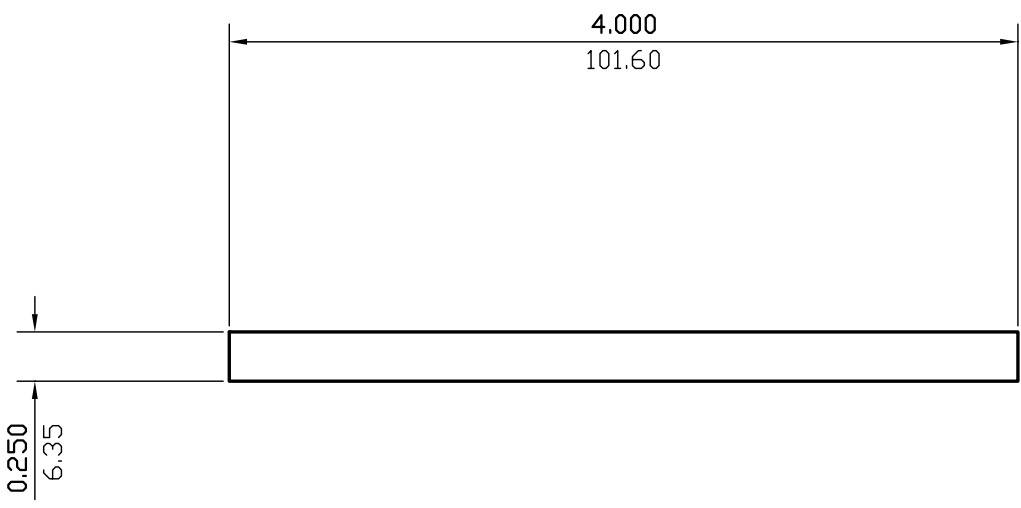

WALL THICKNESS **0.250 (3.18)** EXCEPT AS SHOWN

DATE	REV	DESCRIPTION	BY		
03/17/23	2	REMOVED ALLOY	JASON		
08/18/99	1	REDRAWN	P.M.		
EST.AREA	1.000	IN. ²	EST.AREA	645	MM. ²
EST.WT.	1.180	LBS/FT.	EST.WT.	1.756	KG/M.
EST.PER.	8.500	IN.	EST.PER.	215.9	MM.
OUT PER.		IN.	OUT PER.		MM.
C.C.D.	4.008	IN.	C.C.D.	102	MM.
FACTOR	7	FINISH	M/F	ALLOY & TEMP.	
CKD BY		SCALE	1:1	DWN BY	C.P.
		DATE	11/07/95		

CAN ART

ALUMINUM EXTRUSION INC.

85 PARKSHORE DRIVE
BRAMPTON, ONT L6T 5M1
TEL. NO. (905) 791-1464
FAX NO. (905) 791-9151
E-MAIL: canart@canart.com

THIS DRAWING IS NOT NECESSARILY A COPY OF YOUR ORIGINAL. PLEASE APPROVE DIMENSIONS AND TOLERANCES INDICATED. CAN ART ASSUMES NO RESPONSIBILITY EITHER TECHNICAL OR LEGAL FOR HAVING THIS SHAPE MADE. THE CUSTOMER AGREES TO FULLY PROTECT CAN ART ALUMINUM FROM CLAIMS OF OTHERS RESULTING FROM THIS SHAPE.

SIGNED: _____ DATE: _____