

NOTE: BREAK ALL CORNERS WITH 0.015" (.38 MM) RADIUS UNLESS OTHERWISE NOTED. STANDARD TOLERANCES TO APPLY UNLESS OTHERWISE SPECIFIED.

CUSTOMER PART No.	CAN ART STD.	DIE No. ES05472
DESCRIPTION	3 1/2" x 1/4" THK. FLAT BAR	PROPOSAL No. S-4457

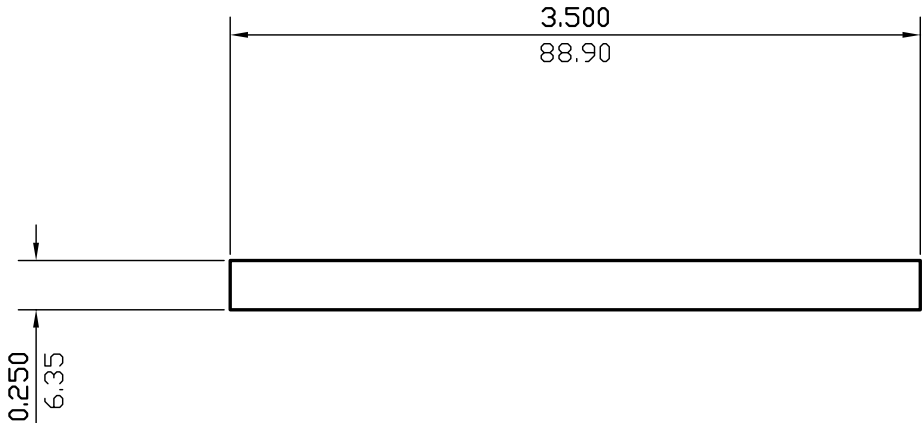

WALL THICKNESS 0.250 (6.35) EXCEPT AS SHOWN

DATE	REV	DESCRIPTION	BY		
03/17/23	2	REMOVED ALLOY	JASON		
08/18/99	1	REDRAWN	P.M.		
EST.AREA	0.875	IN. ²	EST.AREA	565	MM. ²
EST.WT.	1.033	LBS/FT.	EST.WT.	1.537	KG/M.
EST.PER.	7.500	IN.	EST.PER.	190.5	MM.
OUT PER.		IN.	OUT PER.		MM.
C.C.D.	3.509	IN.	C.C.D.	89	MM.
FACTOR	7	FINISH	M/F	ALLOY & TEMP.	
CKD BY		SCALE	1:1	DWN BY	C.P. DATE 04/10/95

CAN ART

ALUMINUM EXTRUSION INC.

85 PARKSHORE DRIVE
BRAMPTON, ONT L6T 5M1
TEL. NO. (905) 791-1464
FAX NO. (905) 791-9151
E-MAIL: canart@canart.com

THIS DRAWING IS NOT NECESSARILY A COPY OF YOUR ORIGINAL. PLEASE APPROVE DIMENSIONS AND TOLERANCES INDICATED. CAN ART ASSUMES NO RESPONSIBILITY EITHER TECHNICAL OR LEGAL FOR HAVING THIS SHAPE MADE. THE CUSTOMER AGREES TO FULLY PROTECT CAN ART ALUMINUM FROM CLAIMS OF OTHERS RESULTING FROM THIS SHAPE.

SIGNED: _____ DATE: _____