

NOTE: BREAK ALL CORNERS WITH 0.015" (.38 MM) RADIUS UNLESS OTHERWISE NOTED. STANDARD TOLERANCES TO APPLY UNLESS OTHERWISE SPECIFIED.

CUSTOMER PART No.	CAN ART STD.	DIE No. ES05752
DESCRIPTION	2.500 x 0.250 REC. BAR	PROPOSAL No. S-50615

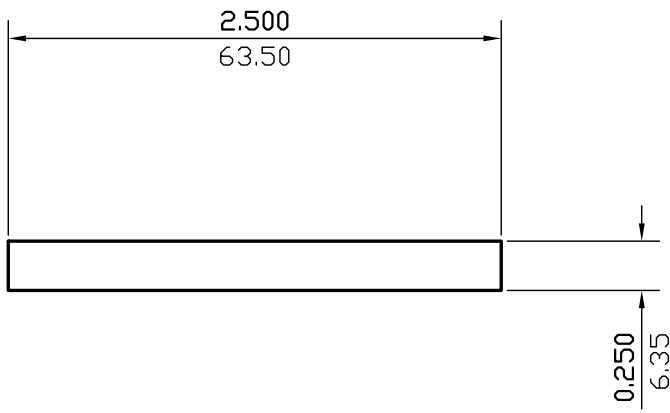

WALL THICKNESS (AS SHOWN) EXCEPT AS SHOWN

DATE	REV	DESCRIPTION	BY
03/17/23	1	REMOVED EXPOSED SURFACES AND ALLOY	JASON
EST.AREA	0.625	IN. ²	EST.AREA 403.228
			MM. ²
EST.WT.	0.750	LBS/FT.	EST.WT. 1.116
			KG/M.
EST.PER.	5.500	IN.	EST.PER. 139.700
			MM.
OUT PER.		IN.	OUT PER.
			MM.
C.C.D.	2.512	IN.	C.C.D. 63.817
			MM.
FACTOR	7	FINISH M/F	ALLOY & TEMP.
CKD BY	SCALE 1:1	DWN BY L.L.	DATE 03/20/2002

CAN ART

ALUMINUM EXTRUSION INC.

428 JUTRAS DRIVE S.
WINDSOR, ONT. N8N 5C5
TEL. NO. (519) 727-4399
FAX NO. (519) 727-6434
E-MAIL: canart@canart.com

THIS DRAWING IS NOT NECESSARILY A COPY OF YOUR ORIGINAL. PLEASE APPROVE DIMENSIONS AND TOLERANCES INDICATED. CAN ART ASSUMES NO RESPONSIBILITY EITHER TECHNICAL OR LEGAL FOR HAVING THIS SHAPE MADE. THE CUSTOMER AGREES TO FULLY PROTECT CAN ART ALUMINUM FROM CLAIMS OF OTHERS RESULTING FROM THIS SHAPE.

SIGNED: _____ DATE: _____