

NOTE: BREAK ALL CORNERS WITH 0.015" (.38 MM) RADIUS UNLESS OTHERWISE NOTED. STANDARD TOLERANCES TO APPLY UNLESS OTHERWISE SPECIFIED.

CUSTOMER	CAN ART STD.	DIE No. ES05934	REV. No. 2
DESCRIPTION 1/4" x 1/2" FLAT BAR	CUSTOMER PART No.	QUOTE No. 08-0876-1	PROPOSAL No. S-19831

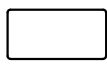
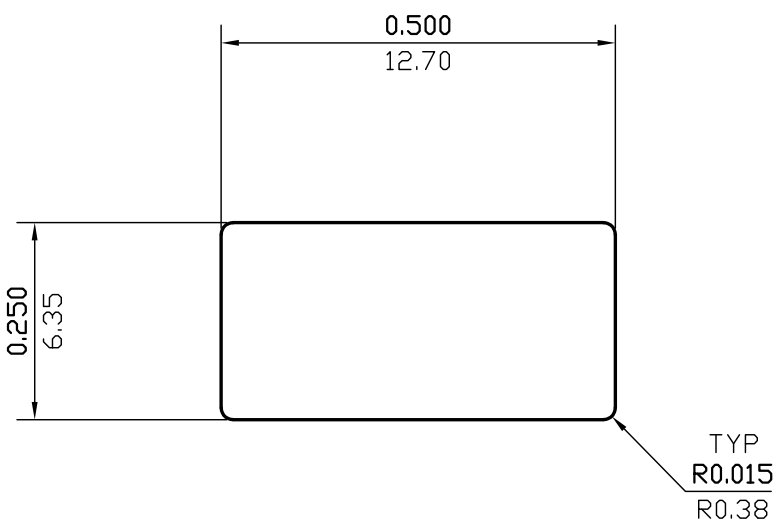

ACTUAL SIZE

WALL THICKNESS (AS SHOWN) EXCEPT AS SHOWN

DATE	REV	DESCRIPTION	BY		
03/17/23	2	REMOVED ALLOY	JASON		
04/25/11	1	REVISED DESCRIPTION.	PAUL		
EST.AREA	0.125	IN. ²	EST.AREA	80.521	MM. ²
EST.WT.	0.147	LBS/FT.	EST.WT.	0.219	KG/M.
EST.PER.	1.474	IN.	EST.PER.	37.446	MM.
OUT PER.		IN.	OUT PER.		MM.
C.C.D.	0.546	IN.	C.C.D.	13.875	MM.
FINISH	M/F		ALLOY		
CKD BY	FACTOR 10	SCALE 4:1	DWN BY P.M.	DATE 3/25/2009	

CAN ART

ALUMINUM EXTRUSION INC.

85 PARKSHORE DRIVE
BRAMPTON, ONT L6T 5M1
TEL. NO. (905) 791-1464
FAX NO. (905) 791-9151
WEB: www.canart.com

THIS DRAWING IS NOT NECESSARILY A COPY OF YOUR ORIGINAL. PLEASE APPROVE DIMENSIONS AND TOLERANCES INDICATED. CAN ART ASSUMES NO RESPONSIBILITY EITHER TECHNICAL OR LEGAL FOR HAVING THIS SHAPE MADE. THE CUSTOMER AGREES TO FULLY PROTECT CAN ART ALUMINUM FROM CLAIMS OF OTHERS RESULTING FROM THIS SHAPE.

SIGNED: _____ DATE: _____