

NOTE: BREAK ALL CORNERS WITH 0.015" (.38 MM) RADIUS UNLESS OTHERWISE NOTED. STANDARD TOLERANCES TO APPLY UNLESS OTHERWISE SPECIFIED.

| | | |
|-------------------|---------------------------------|---------------------------|
| CUSTOMER PART No. | CUSTOMER CAN ART STD. | DIE No. ES05091 |
| DESCRIPTION | 1/2" x 3/16" FLAT BAR | PROPOSAL No. S-338 |

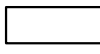
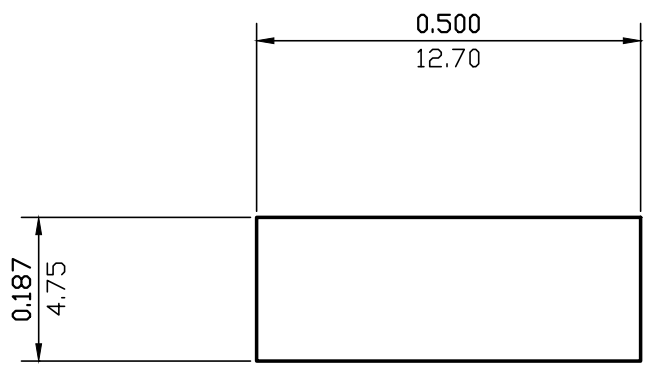

ACTUAL SIZE

WALL THICKNESS (AS SHOWN) EXCEPT AS SHOWN

| DATE | REV | DESCRIPTION | BY |
|-----------|-----------|--------------------|---------------|
| | | | |
| | | | |
| EST.AREA | 0.094 | IN. ² | EST.AREA 60 |
| EST.WT. | 0.110 | LBS/FT. | EST.WT. 0.164 |
| EST.PER. | 1.374 | IN. | EST.PER. 34.9 |
| OUT PER. | | IN. | OUT PER. |
| C.C.D. | 0.534 | IN. | C.C.D. 14 |
| FACTOR 12 | FINISH | ALLOY & TEMP. 6063 | |
| CKD BY | SCALE 4:1 | DWN BY G.M. | DATE 01/15/88 |

CAN ART

85 PARKSHORE DRIVE
BRAMPTON, ONT L6T 5M1
TEL. NO. (905) 791-1464
FAX NO. (905) 791-9151
E-MAIL: canart@canart.com

ALUMINUM EXTRUSION INC.

THIS DRAWING IS NOT NECESSARILY A COPY OF YOUR ORIGINAL. PLEASE APPROVE DIMENSIONS AND TOLERANCES INDICATED. CAN ART ASSUMES NO RESPONSIBILITY EITHER TECHNICAL OR LEGAL FOR HAVING THIS SHAPE MADE. THE CUSTOMER AGREES TO FULLY PROTECT CAN ART ALUMINUM FROM CLAIMS OF OTHERS RESULTING FROM THIS SHAPE.

SIGNED: _____ DATE: _____