

CUSTOMER PART No.	CUSTOMER <b>CAN ART STD.</b>	DIE No. <b>ES05483</b>
DESCRIPTION	1 1/2" x 0.185" THK. FLAT BAR	
		PROPOSAL No. S-4522

NOTE: BREAK ALL CORNERS WITH 0.015" (.38 MM) RADIUS UNLESS OTHERWISE NOTED. STANDARD TOLERANCES TO APPLY UNLESS OTHERWISE SPECIFIED.

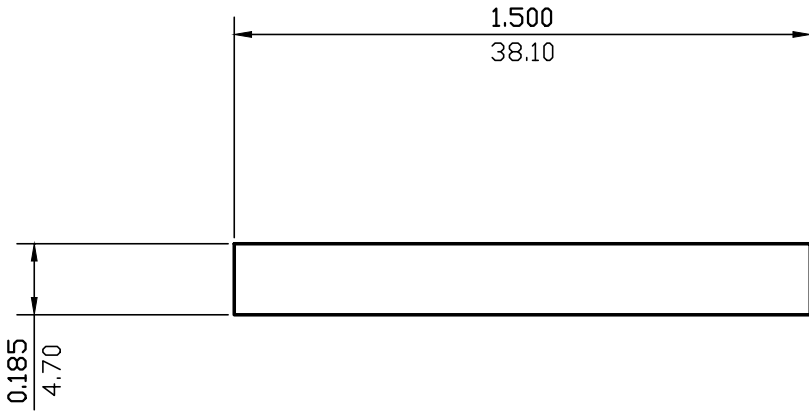

ACTUAL SIZE

WALL THICKNESS 0.185 (4.70) EXCEPT AS SHOWN

DATE	REV	DESCRIPTION		BY
EST.AREA	0.278	IN. <sup>2</sup>	EST.AREA	179
EST.WT.	0.327	LBS./FT.	EST.WT.	0.487
EST.PER.	3.370	IN.	EST.PER.	85.6
OUT PER.		IN.	OUT PER.	
C.C.D.	1.511	IN.	C.C.D.	38
FACTOR	10	FINISH	M/F	ALLOY & TEMP.
CKD BY		SCALE	2:1	DWN BY C.P. DATE 05/01/95

**CAN ART**

85 PARKSHORE DRIVE  
BRAMPTON, ONT L6T 5M1  
TEL. NO. (905) 791-1464  
FAX NO. (905) 791-9151  
E-MAIL: canart@canart.com

ALUMINUM EXTRUSION INC.

THIS DRAWING IS NOT NECESSARILY A COPY OF YOUR ORIGINAL. PLEASE APPROVE DIMENSIONS AND TOLERANCES INDICATED. CAN ART ASSUMES NO RESPONSIBILITY EITHER TECHNICAL OR LEGAL FOR HAVING THIS SHAPE MADE. THE CUSTOMER AGREES TO FULLY PROTECT CAN ART ALUMINUM FROM CLAIMS OF OTHERS RESULTING FROM THIS SHAPE.

SIGNED: \_\_\_\_\_ DATE: \_\_\_\_\_