

NOTE: BREAK ALL CORNERS WITH 0.015" (.38 MM) RADIUS UNLESS OTHERWISE NOTED. STANDARD TOLERANCES TO APPLY UNLESS OTHERWISE SPECIFIED.

CUSTOMER PART No.	CUSTOMER CAN ART STD.	DIE No. ES05758
DESCRIPTION 1-3/8" DIA. ROD		PROPOSAL No. S-12328

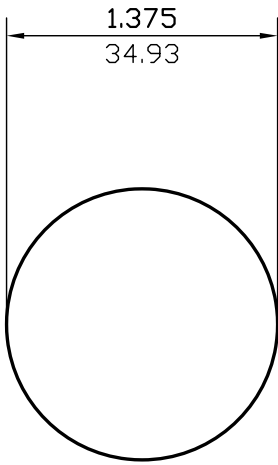

WALL THICKNESS **AS SHOWN** EXCEPT AS SHOWN

DATE	REV	DESCRIPTION	BY
03/16/23	1	REMOVED ALLOY	JASON
EST.AREA		1.485 IN. ²	EST.AREA 958.001 MM. ²
EST.WT.		1.752 LBS/FT.	EST.WT. 2.608 KG/M.
EST.PER.		4.320 IN.	EST.PER. 109.720 MM.
OUT PER.		IN.	OUT PER. MM.
C.C.D.		1.375 IN.	C.C.D. 34.925 MM.
FACTOR 2	FINISH M/F	ALLOY & TEMP.	
CKD BY	SCALE 1:1	DWN BY C.P.	DATE 05/02/2002

CAN ART

ALUMINUM EXTRUSION INC.

85 PARKSHORE DRIVE
BRAMPTON, ONT L6T 5M1
TEL. NO. (905) 791-1464
FAX NO. (905) 791-9151
E-MAIL: canart@canart.com

THIS DRAWING IS NOT NECESSARILY A COPY OF YOUR ORIGINAL. PLEASE APPROVE DIMENSIONS AND TOLERANCES INDICATED. CAN ART ASSUMES NO RESPONSIBILITY EITHER TECHNICAL OR LEGAL FOR HAVING THIS SHAPE MADE. THE CUSTOMER AGREES TO FULLY PROTECT CAN ART ALUMINUM FROM CLAIMS OF OTHERS RESULTING FROM THIS SHAPE.

SIGNED: _____ DATE: _____