

CUSTOMER PART No.
IA-431

CUSTOMER
CAN ART OPEN

DIE No.
ES09040

DESCRIPTION
H-CHANNEL

PROPOSAL No. S-6239

NOTE: BREAK ALL CORNERS WITH 0.015" (.38 MM) RADIUS UNLESS OTHERWISE NOTED. STANDARD TOLERANCES TO APPLY UNLESS OTHERWISE SPECIFIED.

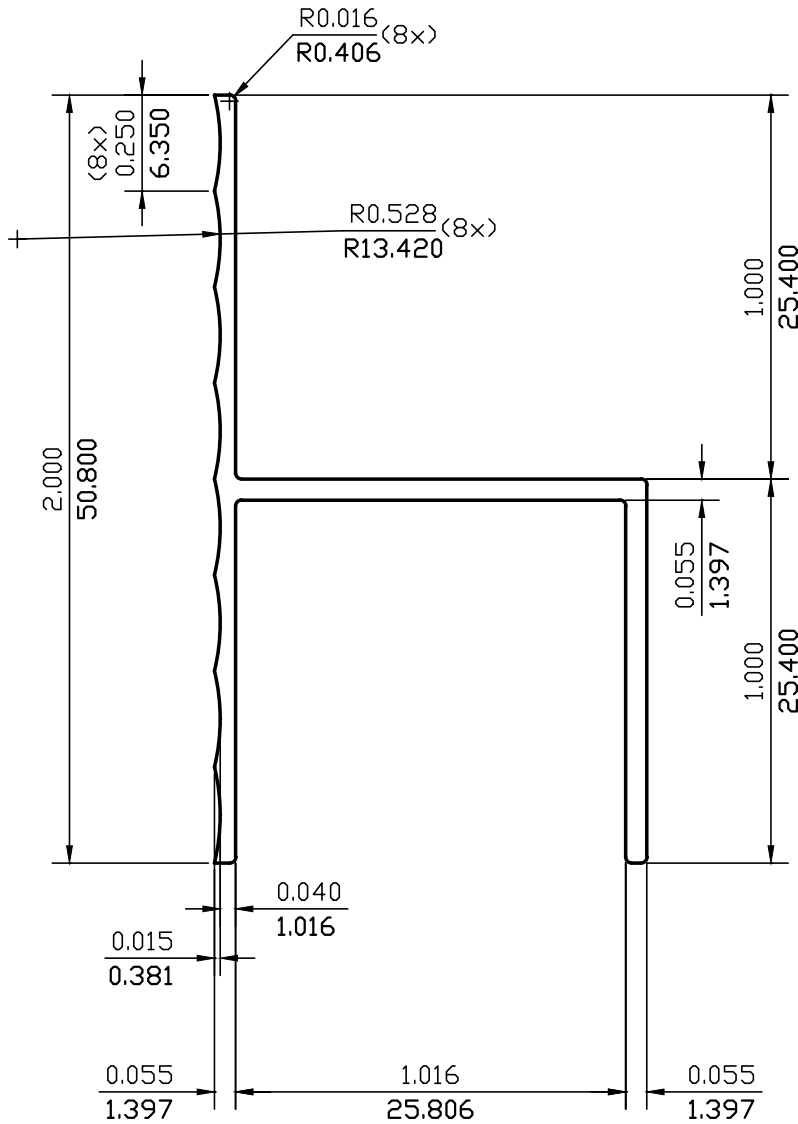

ACTUAL SIZE

WALL THICKNESS (AS SHOWN) EXCEPT AS SHOWN

DATE	REV	DESCRIPTION	BY
EST.AREA	0.201	IN. ²	EST.AREA 129.428
EST.WT.	0.241	LBS/FT.	EST.WT. 0.358
EST.PER.	8.114	IN.	EST.PER. 206.108
OUT PER.		IN.	OUT PER.
C.C.D.	2.289	IN.	C.C.D. 58.136
FACTOR	34	FINISH M/F	ALLOY & TEMP. 6063-T5
CKD BY	SCALE 2:1	DWN BY C.P.	DATE 03/25/97

CAN ART

ALUMINUM EXTRUSION INC.

85 PARKSHORE AVE.
BRAMPTON, ONT. L6T 5M1
TEL. NO. (905) 791-1464
FAX NO. (905) 791-9151
E-MAIL: canart@canart.com

THIS DRAWING IS NOT NECESSARILY A COPY OF YOUR ORIGINAL. PLEASE APPROVE DIMENSIONS AND TOLERANCES INDICATED. CAN ART ASSUMES NO RESPONSIBILITY EITHER TECHNICAL OR LEGAL FOR HAVING THIS SHAPE MADE. THE CUSTOMER AGREES TO FULLY PROTECT CAN ART ALUMINUM FROM CLAIMS OF OTHERS RESULTING FROM THIS SHAPE.

SIGNED: _____ DATE: _____