

CUSTOMER PART No.

CUSTOMER

CAN ART OPEN

DIE No.

EH09794

DESCRIPTION

1-1/2 x .060 SQ. TUBE W/ RAD.

PROPOSAL No.

H-7639

NOTE: BREAK ALL CORNERS WITH 0.015" (.38 MM) RADIUS UNLESS OTHERWISE NOTED. STANDARD TOLERANCES TO APPLY UNLESS OTHERWISE SPECIFIED.

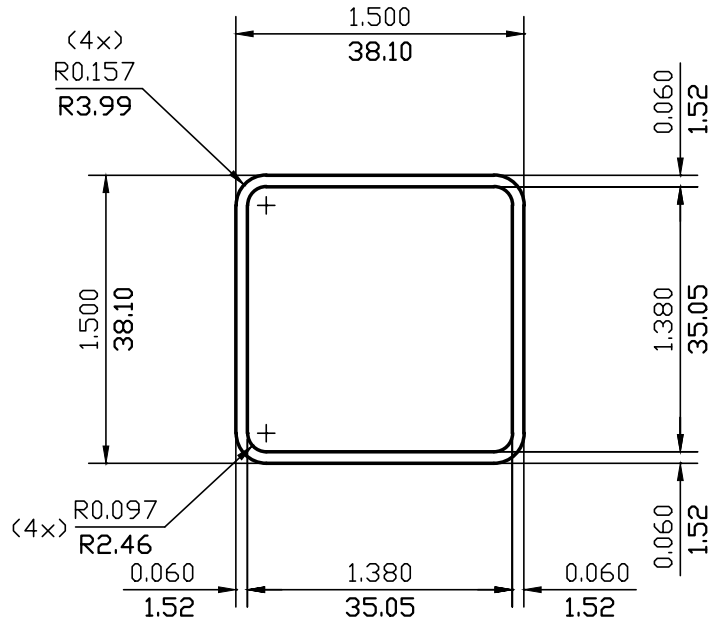

WALL THICKNESS 0.060(1.52) EXCEPT AS SHOWN

DATE	REV	DESCRIPTION	BY
EST.AREA	0.333	IN. ²	EST.AREA 214.529
EST.WT.	0.399	LBS/FT.	EST.WT. 0.594
EST.PER.	11.084	IN.	EST.PER. 281.532
OUT PER.	5.730	IN.	OUT PER. 145.6
C.C.D.	1.991	IN.	C.C.D. 50.578
FACTOR	28	FINISH M/F	ALLOY & TEMP. 6063-T5
CKD BY	SCALE 1:1	DWN BY C.P.	DATE 04/24/98

CAN ART

ALUMINUM EXTRUSION INC.

85 PARKSHORE AVE.
BRAMPTON, ONT. L6T 5M1
TEL. NO. (905) 791-1464
FAX NO. (905) 791-9151
E-MAIL: canart@canart.com

THIS DRAWING IS NOT NECESSARILY A COPY OF YOUR ORIGINAL. PLEASE APPROVE DIMENSIONS AND TOLERANCES INDICATED. CAN ART ASSUMES NO RESPONSIBILITY EITHER TECHNICAL OR LEGAL FOR HAVING THIS SHAPE MADE. THE CUSTOMER AGREES TO FULLY PROTECT CAN ART ALUMINUM FROM CLAIMS OF OTHERS RESULTING FROM THIS SHAPE.

SIGNED: _____ DATE: _____