

NOTE: BREAK ALL CORNERS WITH 0.015" (.38 MM) RADIUS UNLESS OTHERWISE NOTED. STANDARD TOLERANCES TO APPLY UNLESS OTHERWISE SPECIFIED.

CUSTOMER CAN ART OPEN	DIE No. EH13177	REV. No. 0
DESCRIPTION 4-1/2" x 1-3/4" x 0.090" RECT. TUBE	CUSTOMER PART No.	PROPOSAL No. H-14062

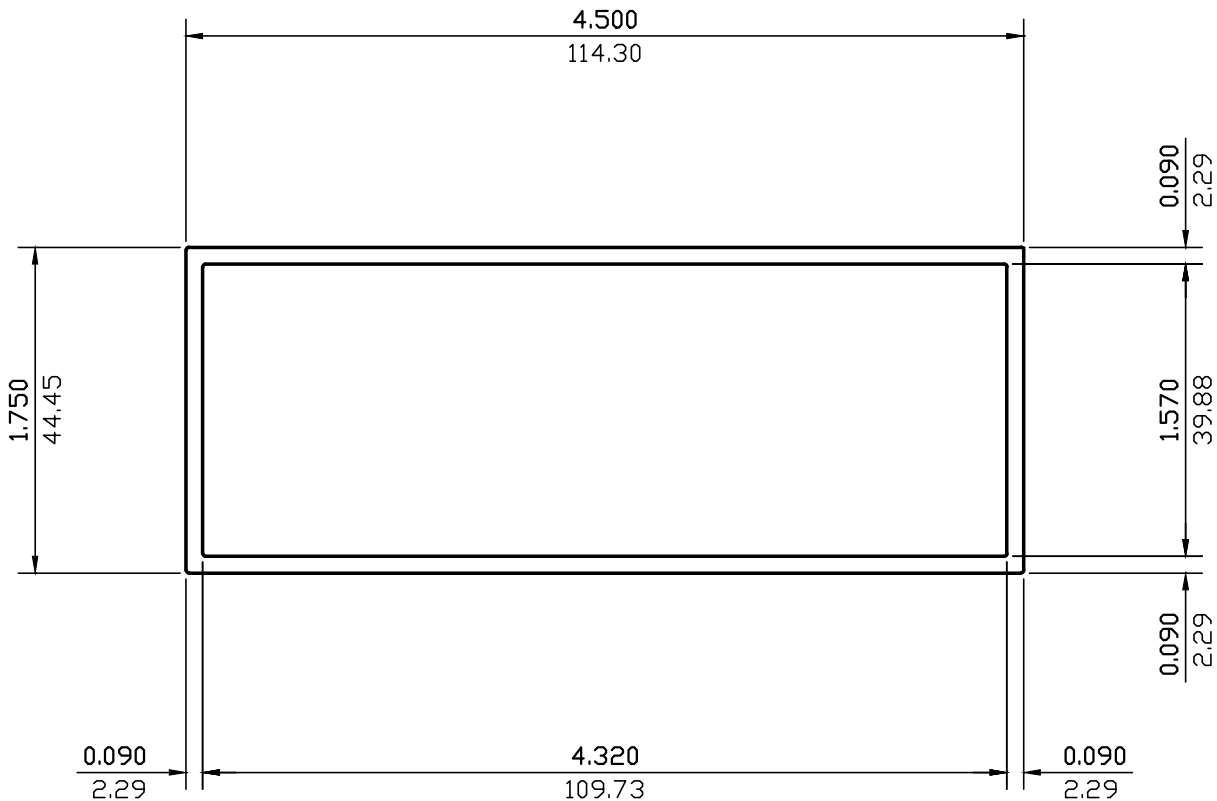

ALL OUTSIDE SURFACES EXPOSED

WALL THICKNESS **0.090 (2.29)** EXCEPT AS SHOWN

DATE	REV	DESCRIPTION	BY		
EST.AREA	1.093	IN. ²	EST.AREA	704.907	MM. ²
EST.WT.	1.289	LBS/FT.	EST.WT.	1.919	KG/M.
EST.PER.	24.228	IN.	EST.PER.	615.404	MM.
OUT PER.	12.474	IN.	OUT PER.	316.8	MM.
C.C.D.	4.818	IN.	C.C.D.	122.365	MM.
FINISH	PAINT/ANODIZE		ALLOY	6063	
CKD BY	FACTOR 19	SCALE 1:1	DWN BY P.M.	DATE 10/31/2003	

CAN ART

ALUMINUM EXTRUSION INC.

85 PARKSHORE DRIVE
BRAMPTON, ONT L6T 5M1
TEL. NO. (905) 791-1464
FAX NO. (905) 791-9151
WEB: www.canart.com

THIS DRAWING IS NOT NECESSARILY A COPY OF YOUR ORIGINAL. PLEASE APPROVE DIMENSIONS AND TOLERANCES INDICATED. CAN ART ASSUMES NO RESPONSIBILITY EITHER TECHNICAL OR LEGAL FOR HAVING THIS SHAPE MADE. THE CUSTOMER AGREES TO FULLY PROTECT CAN ART ALUMINUM FROM CLAIMS OF OTHERS RESULTING FROM THIS SHAPE.

SIGNED: _____ DATE: _____