

NOTE: BREAK ALL CORNERS WITH 0.015" (.38 MM) RADIUS UNLESS OTHERWISE NOTED. STANDARD TOLERANCES TO APPLY UNLESS OTHERWISE SPECIFIED.

CUSTOMER PART No.	CAN ART STD.	DIE No. ES05742
DESCRIPTION 3/4" x 3/4" x 1/8" ANGLE		PROPOSAL No. S-50483

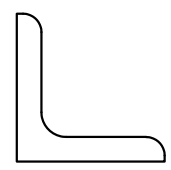
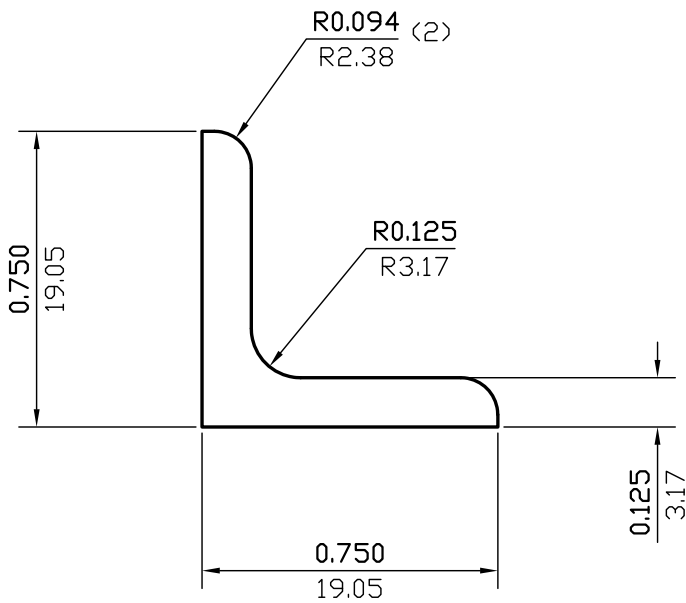

ACTUAL SIZE

WALL THICKNESS **0.125(3.18)** EXCEPT AS SHOWN

DATE	REV	DESCRIPTION	BY
03/20/23	1	REMOVED ALLOY	JASON
EST.AREA		0.171 IN. ²	EST.AREA 110.617 MM. ²
EST.WT.		0.206 LBS/FT.	EST.WT. 0.306 KG/M.
EST.PER.		2.866 IN.	EST.PER. 72.793 MM.
OUT PER.			
C.C.D.		1.061 IN.	C.C.D. 26.941 MM.
FACTOR 14	FINISH M/F	ALLOY & TEMP.	
QKD BY	SCALE 2:1	DWN BY L.L.	DATE 01/16/2002

CAN ART

ALUMINUM EXTRUSION INC.

428 JUTRAS DRIVE S.
WINDSOR, ONT. N8N 5C5
TEL. NO. (519) 727-4399
FAX NO. (519) 727-6434
E-MAIL: canart@canart.com

THIS DRAWING IS NOT NECESSARILY A COPY OF YOUR ORIGINAL. PLEASE APPROVE DIMENSIONS AND TOLERANCES INDICATED. CAN ART ASSUMES NO RESPONSIBILITY EITHER TECHNICAL OR LEGAL FOR HAVING THIS SHAPE MADE. THE CUSTOMER AGREES TO FULLY PROTECT CAN ART ALUMINUM FROM CLAIMS OF OTHERS RESULTING FROM THIS SHAPE.

SIGNED: _____ DATE: _____