

NOTE: BREAK ALL CORNERS WITH 0.015" (.38 MM) RADIUS UNLESS OTHERWISE NOTED. STANDARD TOLERANCES TO APPLY UNLESS OTHERWISE SPECIFIED.

CUSTOMER PART No.	<b>CAN ART STD.</b>	DIE No. <b>ES05784</b>
DESCRIPTION	4" x 2" x 1/4" TEE	PROPOSAL No. <b>S-13698</b>

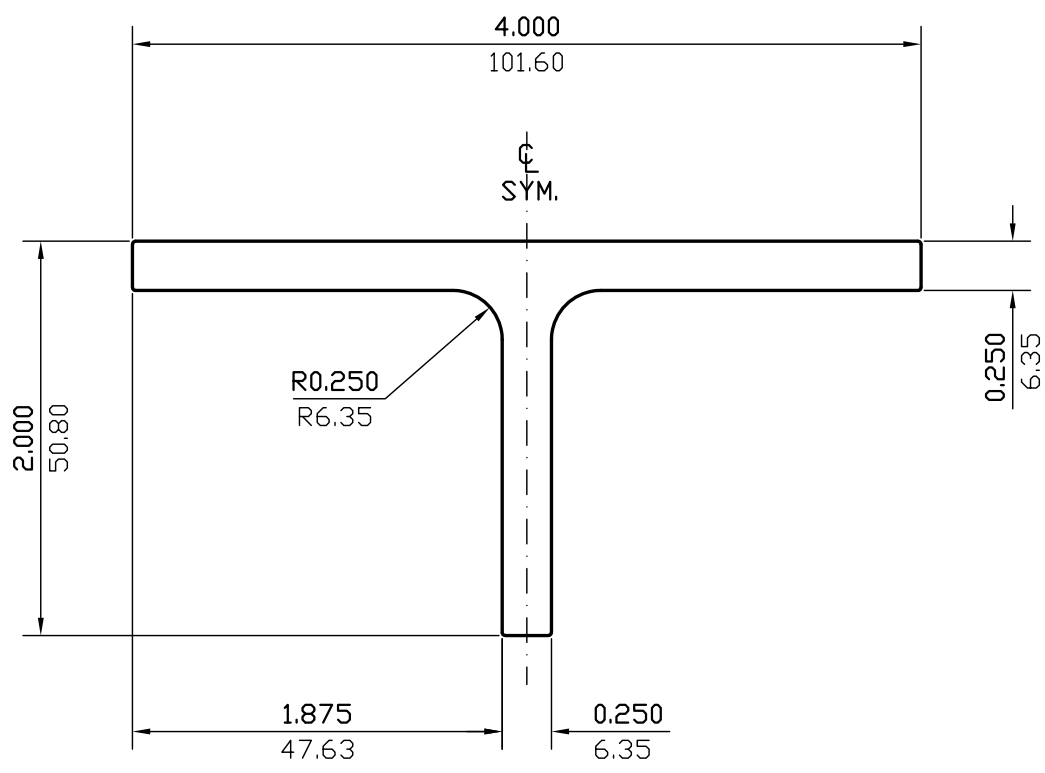

WALL THICKNESS AS SHOWN EXCEPT AS SHOWN

DATE	REV	DESCRIPTION	BY
03/21/23	1	REMOVED EXPOSED SURFACES AND ALLOY	JASON
EST.AREA	1.464	IN. <sup>2</sup>	EST.AREA 944.545
			MM. <sup>2</sup>
EST.WT.	1.728	LBS/FT.	EST.WT. 2.571
			KG/M.
EST.PER.	11.747	IN.	EST.PER. 298.368
			MM.
OUT PER.		IN.	OUT PER.
			MM.
C.C.D.	4.006	IN.	C.C.D. 101.754
			MM.
FACTOR	7	FINISH ANOD.	ALLOY & TEMP.
CKD BY	SCALE 1:1	DWN BY C.P.	DATE 07/14/2003

# CAN ART

**ALUMINUM EXTRUSION INC.**

85 PARKSHORE DRIVE  
BRAMPTON, ONT L6T 5M1  
TEL. NO. (905) 791-1464  
FAX NO. (905) 791-9151  
E-MAIL: canart@canart.com

THIS DRAWING IS NOT NECESSARILY A COPY OF YOUR ORIGINAL. PLEASE APPROVE DIMENSIONS AND TOLERANCES INDICATED. CAN ART ASSUMES NO RESPONSIBILITY EITHER TECHNICAL OR LEGAL FOR HAVING THIS SHAPE MADE. THE CUSTOMER AGREES TO FULLY PROTECT CAN ART ALUMINUM FROM CLAIMS OF OTHERS RESULTING FROM THIS SHAPE.

SIGNED: \_\_\_\_\_ DATE: \_\_\_\_\_