

CUSTOMER PART No.	CUSTOMER	DIE No.
	CAN ART STD.	ES05758
DESCRIPTION	1-3/8" DIA. ROD	PROPOSAL No. S-12328

NOTE: BREAK ALL CORNERS WITH 0.015" (.38 MM) RADIUS UNLESS OTHERWISE NOTED. STANDARD TOLERANCES TO APPLY UNLESS OTHERWISE SPECIFIED.

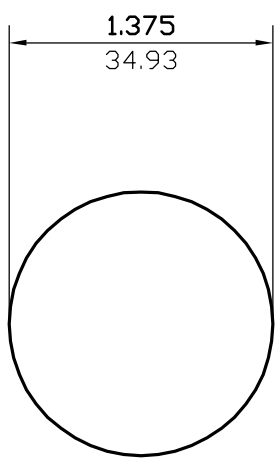

WALL THICKNESS		AS SHOWN		EXCEPT AS SHOWN	
DATE	REV	DESCRIPTION	BY		
EST.AREA	1.485	IN. ²	EST.AREA	958.001	MM. ²
EST.WT.	1.752	LBS/FT.	EST.WT.	2.608	KG/M.
EST.PER.	4.320	IN.	EST.PER.	109.720	MM.
OUT PER.		IN.	OUT PER.		MM.
C.C.D.	1.375	IN.	C.C.D.	34.925	MM.
FACTOR	2	FINISH	M/F	ALLOY & TEMP.	6061-T6
CKD BY		SCALE	1:1	DWN BY	C.P. DATE 05/02/2002

CAN ART

85 PARKSHORE DRIVE
BRAMPTON, ONT L6T 5M1
TEL. NO. (905) 791-1464
FAX NO. (905) 791-9151
E-MAIL: canart@canart.com

ALUMINUM EXTRUSION INC.

THIS DRAWING IS NOT NECESSARILY A COPY OF YOUR ORIGINAL. PLEASE APPROVE DIMENSIONS AND TOLERANCES INDICATED. CAN ART ASSUMES NO RESPONSIBILITY EITHER TECHNICAL OR LEGAL FOR HAVING THIS SHAPE MADE. THE CUSTOMER AGREES TO FULLY PROTECT CAN ART ALUMINUM FROM CLAIMS OF OTHERS RESULTING FROM THIS SHAPE.

SIGNED: _____ DATE: _____