

CUSTOMER PART No.

CUSTOMER

**CAN ART STD.**

DIE No.

ES05723

DESCRIPTION

3 x 1.41 x 0.170 WB CHANNEL

PROPOSAL No.

S-50292

NOTE: BREAK ALL CORNERS WITH 0.015" (.38 MM) RADIUS UNLESS OTHERWISE NOTED. STANDARD TOLERANCES TO APPLY UNLESS OTHERWISE SPECIFIED.

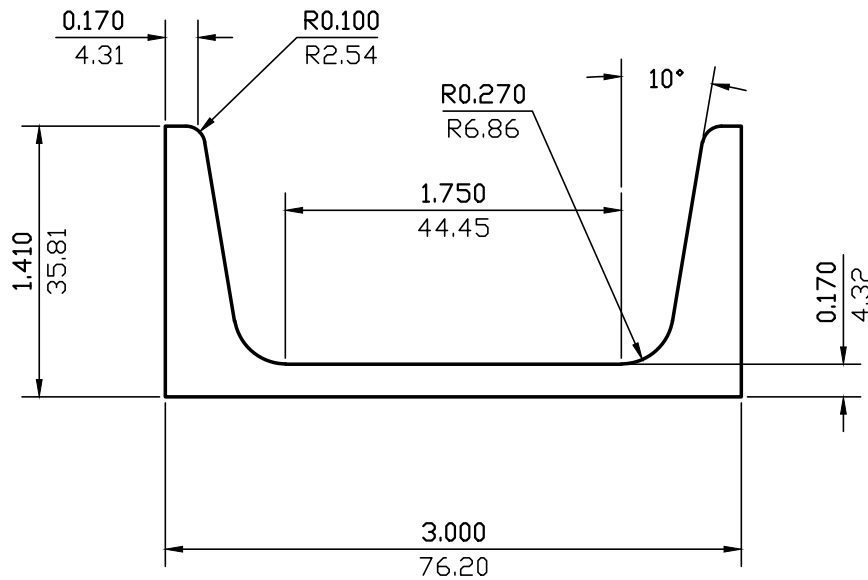

WALL THICKNESS (AS SHOWN) EXCEPT AS SHOWN

DATE	REV	DESCRIPTION	BY
EST.AREA	1.255	IN. <sup>2</sup>	EST.AREA 809.811
EST.WT.	1.506	LBS./FT.	EST.WT. 2.242
EST.PER.	10.705	IN.	EST.PER. 271.913
OUT PER.		IN.	OUT PER.
C.C.D.	3.315	IN.	C.C.D. 84.197
FACTOR	7	FINISH M/F	ALLOY & TEMP. 6061
CKD BY	SCALE 1:1	DWN BY L.L.	DATE 11/05/2001

**CAN ART**

ALUMINUM EXTRUSION INC.

428 JUTRAS DRIVE S.  
WINDSOR, ONT. L6T 5M1  
TEL. NO. (519) 727-4399  
FAX NO. (519) 727-6434  
E-MAIL: canart@canart.com

THIS DRAWING IS NOT NECESSARILY A COPY OF YOUR ORIGINAL. PLEASE APPROVE DIMENSIONS AND TOLERANCES INDICATED. CAN ART ASSUMES NO RESPONSIBILITY EITHER TECHNICAL OR LEGAL FOR HAVING THIS SHAPE MADE. THE CUSTOMER AGREES TO FULLY PROTECT CAN ART ALUMINUM FROM CLAIMS OF OTHERS RESULTING FROM THIS SHAPE.

SIGNED: \_\_\_\_\_ DATE: \_\_\_\_\_