

CUSTOMER PART No.	CUSTOMER CAN ART STD.	DIE No. ES05692
DESCRIPTION 2-1/2 x 3/8 S.C. FLAT BAR	PROPOSAL No. S-10660	

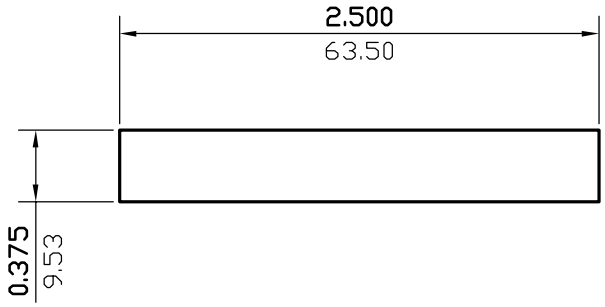

NOTE: BREAK ALL CORNERS WITH 0.015" (.38 MM) RADIUS UNLESS OTHERWISE NOTED. STANDARD TOLERANCES TO APPLY UNLESS OTHERWISE SPECIFIED.

WALL THICKNESS (AS SHOWN) EXCEPT AS SHOWN			
DATE	REV	DESCRIPTION	BY
EST.AREA	0.937	IN. ²	EST.AREA 604.842
EST.WT.	1.106	LBS/FT.	EST.WT. 1.646
EST.PER.	5.750	IN.	EST.PER. 146.050
OUT PER.		IN.	OUT PER.
C.C.D.	2.528	IN.	C.C.D. 64.210
FACTOR	5	FINISH	M/F
		ALLOY & TEMP.	6061
CKD BY		SCALE	1:1
		DWN BY	C.P.
		DATE	01/15/2001

CAN ART
ALUMINUM EXTRUSION INC.

85 PARKSHORE DRIVE
BRAMPTON, ONT L6T 5M1
TEL. NO. (905) 791-1464
FAX NO. (905) 791-9151
E-MAIL: canart@canart.com

THIS DRAWING IS NOT NECESSARILY A COPY OF YOUR ORIGINAL. PLEASE APPROVE DIMENSIONS AND TOLERANCES INDICATED. CAN ART ASSUMES NO RESPONSIBILITY EITHER TECHNICAL OR LEGAL FOR HAVING THIS SHAPE MADE. THE CUSTOMER AGREES TO FULLY PROTECT CAN ART ALUMINUM FROM CLAIMS OF OTHERS RESULTING FROM THIS SHAPE.

SIGNED: _____ DATE: _____