

CUSTOMER PART No.	CUSTOMER CAN ART STD.	DIE No. ES05583
DESCRIPTION	4" x 1/2" THK. FLAT BAR	PROPOSAL No. S-6944

NOTE: BREAK ALL CORNERS WITH 0.015" (.38 MM) RADIUS UNLESS OTHERWISE NOTED. STANDARD TOLERANCES TO APPLY UNLESS OTHERWISE SPECIFIED.

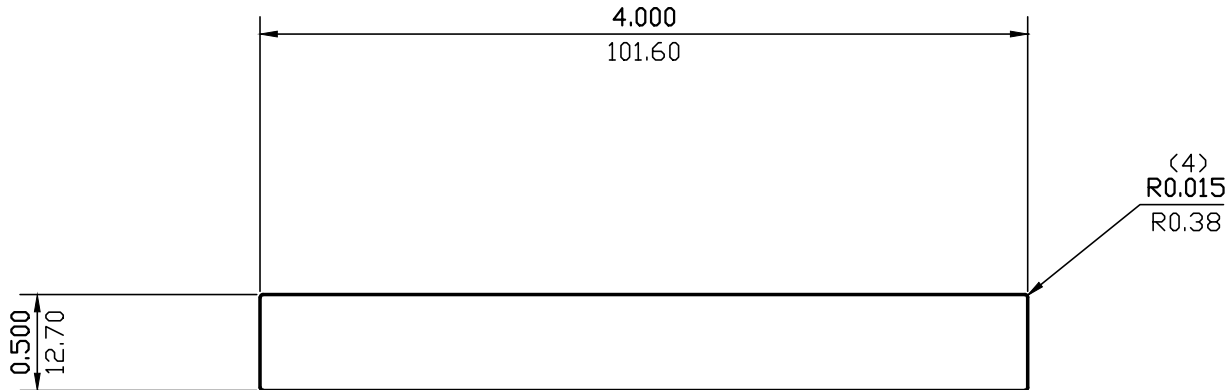

WALL THICKNESS 0.500 (12.70) EXCEPT AS SHOWN

DATE	REV	DESCRIPTION	BY
EST.AREA	2.000	IN. ²	EST.AREA 1290
EST.WT.	2.360	LBS./FT.	EST.WT. 3.512
EST.PER.	8.974	IN.	EST.PER. 227.9
OUT PER.		IN.	OUT PER.
C.C.D.	4.028	IN.	C.C.D. 102
FACTOR	4	FINISH	M/F
		ALLOY & TEMP.	6063
CKD BY		SCALE	1:1
		DWN BY	C.P.
		DATE	10/03/97

CAN ART

ALUMINUM EXTRUSION INC.

85 PARKSHORE DRIVE
BRAMPTON, ONT L6T 5M1
TEL. NO. (905) 791-1464
FAX NO. (905) 791-9151
E-MAIL: canart@canart.com

THIS DRAWING IS NOT NECESSARILY A COPY OF YOUR ORIGINAL. PLEASE APPROVE DIMENSIONS AND TOLERANCES INDICATED. CAN ART ASSUMES NO RESPONSIBILITY EITHER TECHNICAL OR LEGAL FOR HAVING THIS SHAPE MADE. THE CUSTOMER AGREES TO FULLY PROTECT CAN ART ALUMINUM FROM CLAIMS OF OTHERS RESULTING FROM THIS SHAPE.

SIGNED: _____ DATE: _____