

CUSTOMER PART No.	CUSTOMER CAN ART STD.	DIE No. ES05576
DESCRIPTION 2" x 3/8" THK. FLAT BAR	PROPOSAL No. S-6644	

NOTE: BREAK ALL CORNERS WITH 0.015" (.38 MM) RADIUS UNLESS OTHERWISE NOTED. STANDARD TOLERANCES TO APPLY UNLESS OTHERWISE SPECIFIED.

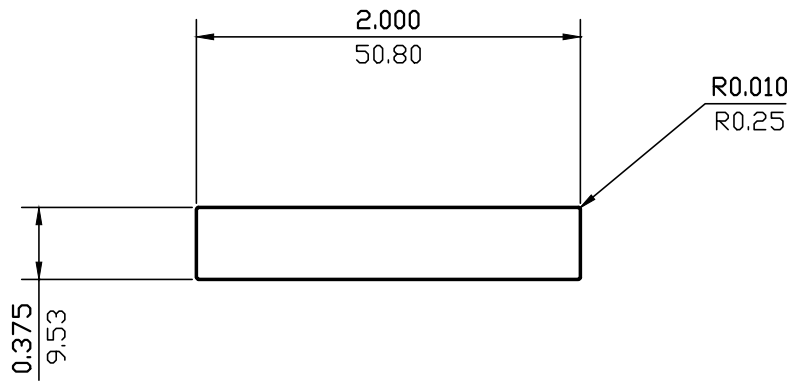

WALL THICKNESS **0.375 (9.53)** EXCEPT AS SHOWN

DATE	REV	DESCRIPTION	BY
EST.AREA	0.750	IN. ²	EST.AREA 484 MM. ²
EST.WT.	0.885	LBS./FT.	EST.WT. 1.317 KG/M.
EST.PER.	4.733	IN.	EST.PER. 120.2 MM.
OUT PER.		IN.	OUT PER. MM.
C.C.D.	2.031	IN.	C.C.D. 52 MM.
FACTOR 5	FINISH M/F	ALLOY & TEMP. 6061	
CKD BY	SCALE 1:1	DWN BY C.P.	DATE 07/10/97

CAN ART

85 PARKSHORE DRIVE
BRAMPTON, ONT L6T 5M1
TEL. NO. (905) 791-1464
FAX NO. (905) 791-9151
E-MAIL: canart@canart.com

ALUMINUM EXTRUSION INC.

THIS DRAWING IS NOT NECESSARILY A COPY OF YOUR ORIGINAL. PLEASE APPROVE DIMENSIONS AND TOLERANCES INDICATED. CAN ART ASSUMES NO RESPONSIBILITY EITHER TECHNICAL OR LEGAL FOR HAVING THIS SHAPE MADE. THE CUSTOMER AGREES TO FULLY PROTECT CAN ART ALUMINUM FROM CLAIMS OF OTHERS RESULTING FROM THIS SHAPE.

SIGNED: _____ DATE: _____