

CUSTOMER PART No.	CUSTOMER <b>CAN ART STD.</b>	DIE No. <b>ES05551</b>
DESCRIPTION	1.500" DIA. ROUND ROD	PROPOSAL No. <b>S-6392</b>

NOTE: BREAK ALL CORNERS WITH 0.015" (.38 MM) RADIUS UNLESS OTHERWISE NOTED. STANDARD TOLERANCES TO APPLY UNLESS OTHERWISE SPECIFIED.

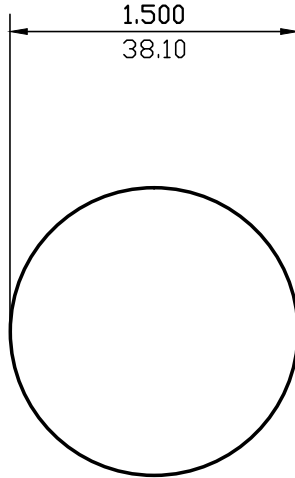

WALL THICKNESS (AS SHOWN) EXCEPT AS SHOWN

DATE	REV	DESCRIPTION	BY
EST.AREA	1.767	IN. <sup>2</sup>	EST.AREA 1140
EST.WT.	2.085	LBS/FT.	EST.WT. 3.103
EST.PER.	4.712	IN.	EST.PER. 119.7
OUT PER.		IN.	OUT PER.
C.C.D.	1.500	IN.	C.C.D. 38
FACTOR	2	FINISH	M/F
		ALLOY & TEMP.	6061
CKD BY		SCALE	1:1
		DWN BY	C.P.
		DATE	04/30/97

# CAN ART

ALUMINUM EXTRUSION INC.

85 PARKSHORE DRIVE  
BRAMPTON, ONT L6T 5M1  
TEL. NO. (905) 791-1464  
FAX NO. (905) 791-9151  
E-MAIL: canart@canart.com

THIS DRAWING IS NOT NECESSARILY A COPY OF YOUR ORIGINAL. PLEASE APPROVE DIMENSIONS AND TOLERANCES INDICATED. CAN ART ASSUMES NO RESPONSIBILITY EITHER TECHNICAL OR LEGAL FOR HAVING THIS SHAPE MADE. THE CUSTOMER AGREES TO FULLY PROTECT CAN ART ALUMINUM FROM CLAIMS OF OTHERS RESULTING FROM THIS SHAPE.

SIGNED: \_\_\_\_\_ DATE: \_\_\_\_\_