

CUSTOMER PART No.	CUSTOMER CAN ART STD.	DIE No. ES05191
DESCRIPTION	2" x 0.125" THK. FLAT BAR	
		PROPOSAL No. S-11220

NOTE: BREAK ALL CORNERS WITH 0.015" (.38 MM) RADIUS UNLESS OTHERWISE NOTED. STANDARD TOLERANCES TO APPLY UNLESS OTHERWISE SPECIFIED.

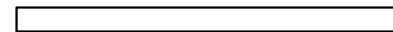
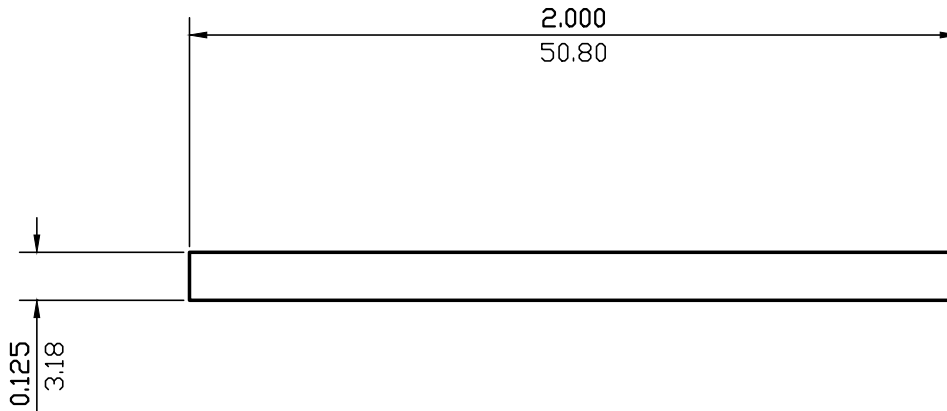

ACTUAL SIZE

WALL THICKNESS 0.125 (3.18) EXCEPT AS SHOWN

DATE	REV	DESCRIPTION	BY
EST.AREA	0.250	IN. ²	EST.AREA 161
EST.WT.	0.295	LBS./FT.	EST.WT. 0.439
EST.PER.	4.261	IN.	EST.PER. 108.2
OUT PER.		IN.	OUT PER.
C.C.D.	2.004	IN.	C.C.D. 51
FACTOR 14	FINISH M/F	ALLOY & TEMP. 6063	
CKD BY	SCALE 2:1	DWN BY G.M.	DATE 02/20/89

CAN ART

ALUMINUM EXTRUSION INC.

85 PARKSHORE DRIVE
BRAMPTON, ONT L6T 5M1
TEL. NO. (905) 791-1464
FAX NO. (905) 791-9151
E-MAIL: canart@canart.com

THIS DRAWING IS NOT NECESSARILY A COPY OF YOUR ORIGINAL. PLEASE APPROVE DIMENSIONS AND TOLERANCES INDICATED. CAN ART ASSUMES NO RESPONSIBILITY EITHER TECHNICAL OR LEGAL FOR HAVING THIS SHAPE MADE. THE CUSTOMER AGREES TO FULLY PROTECT CAN ART ALUMINUM FROM CLAIMS OF OTHERS RESULTING FROM THIS SHAPE.

SIGNED: _____ DATE: _____