

NOTE: BREAK ALL CORNERS WITH 0.015" (.38 MM) RADIUS UNLESS OTHERWISE NOTED. STANDARD TOLERANCES TO APPLY UNLESS OTHERWISE SPECIFIED.

CUSTOMER CAN ART STD.		DIE No. EH05896	REV. No. 2
DESCRIPTION 4-1/2" SCHED. 40 PIPE	CUSTOMER PART No.	QUOTE No. 08-0268-3	PROPOSAL No. H-18998

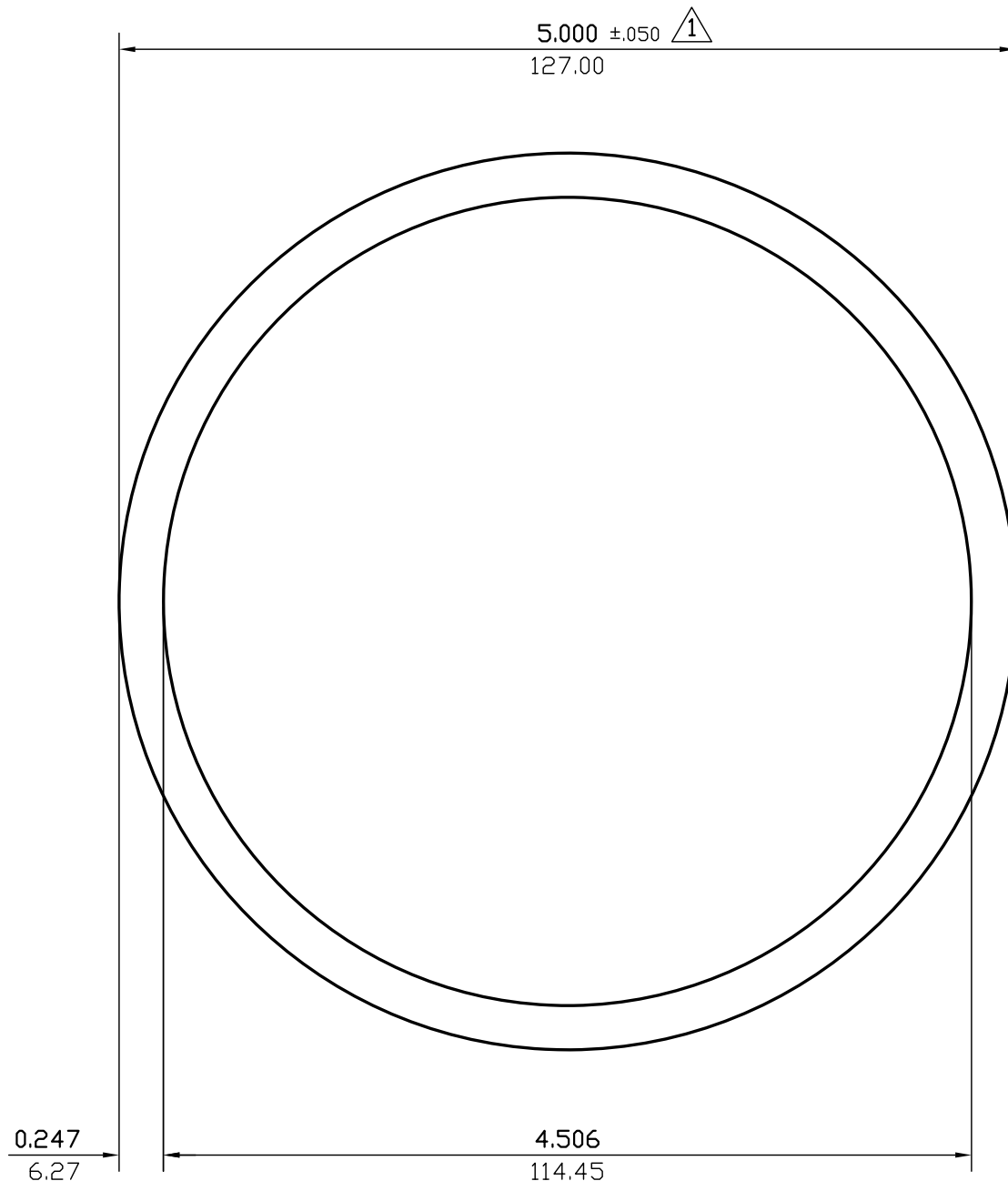

WALL THICKNESS AS SHOWN EXCEPT AS SHOWN

DATE	REV	DESCRIPTION	BY
03/10/23	2	REMOVED ALLOY	JASON
07/16/15	1	ADDED ±.050 TOLERANCE.	PAUL
EST.AREA	3.688	IN. ²	EST.AREA 2379.499
EST.WT.	4.426	LBS/FT.	EST.WT. 6.587
EST.PER.	29.864	IN.	EST.PER. 758.545
OUT PER.	15.708	IN.	OUT PER. 399.0
C.C.D.	5.000	IN.	C.C.D. 127.000
FINISH	M/F	ALLOY	
CKD BY	FACTOR 7	SCALE 1:1	DWN BY C.P. DATE 06/20/2008

CAN ART

ALUMINUM EXTRUSION INC.

85 PARKSHORE DRIVE
BRAMPTON, ONT L6T 5M1
TEL. NO. (905) 791-1464
FAX NO. (905) 791-9151
WEB: www.canart.com

THIS DRAWING IS NOT NECESSARILY A COPY OF YOUR ORIGINAL. PLEASE APPROVE DIMENSIONS AND TOLERANCES INDICATED. CAN ART ASSUMES NO RESPONSIBILITY EITHER TECHNICAL OR LEGAL FOR HAVING THIS SHAPE MADE. THE CUSTOMER AGREES TO FULLY PROTECT CAN ART ALUMINUM FROM CLAIMS OF OTHERS RESULTING FROM THIS SHAPE.

SIGNED: _____ DATE: _____