

NOTE: BREAK ALL CORNERS WITH 0.015" (.38 MM) RADIUS UNLESS OTHERWISE NOTED. STANDARD TOLERANCES TO APPLY UNLESS OTHERWISE SPECIFIED.

CUSTOMER CAN ART STD.		DIE No. EH05868	REV. No. 2
DESCRIPTION 3-1/2" SCHED. 40 PIPE	CUSTOMER PART No.	QUOTE No. 08-0268-2	PROPOSAL No. H-18997

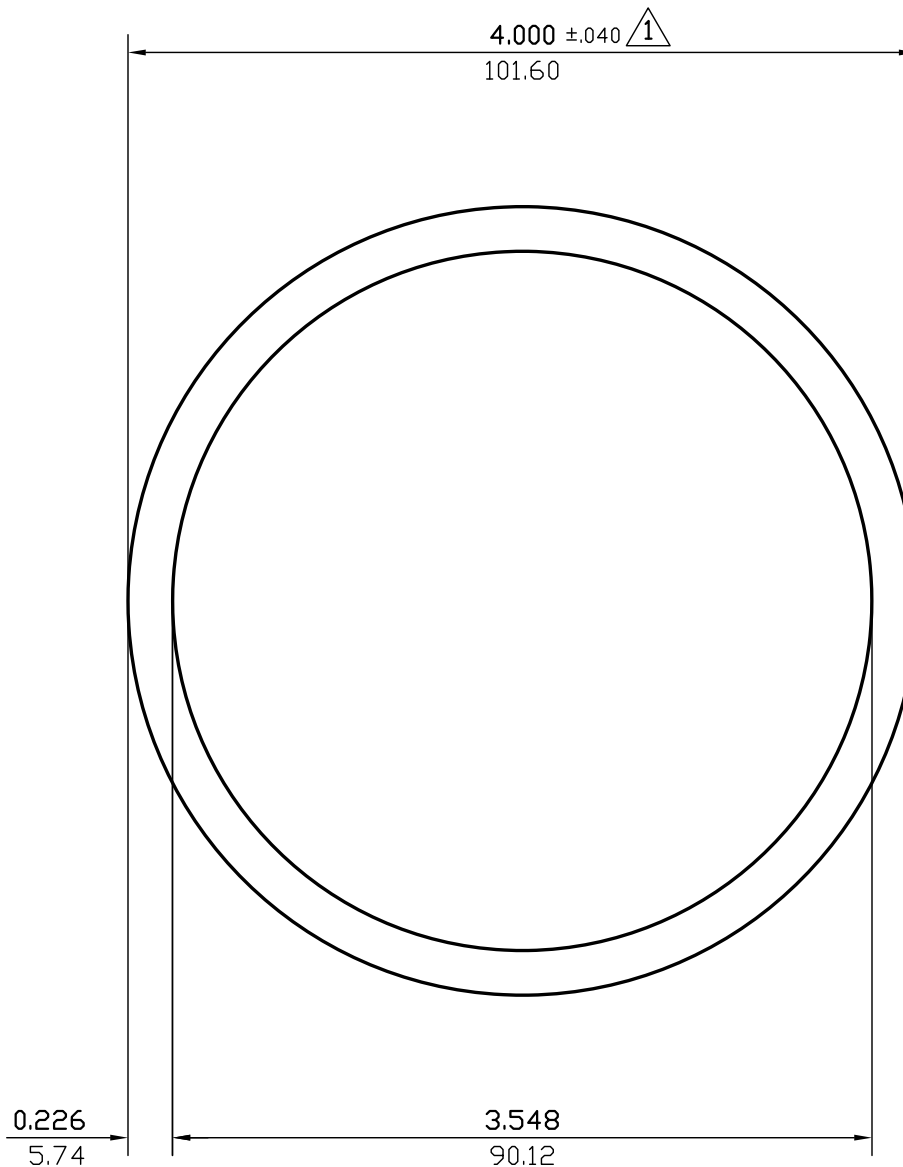

WALL THICKNESS 0.226(5.74) EXCEPT AS SHOWN

DATE	REV	DESCRIPTION		BY	
03/10/23	2	REMOVED ALLOY		JASON	
07/16/15	1	ADDED ±.040 TOLERANCE.		PAUL	
EST.AREA	2.680	IN. ²	EST.AREA	1728.746	MM. ²
EST.WT.	3.215	LBS/FT.	EST.WT.	4.785	KG/M.
EST.PER.	23.713	IN.	EST.PER.	602.304	MM.
OUT PER.	12.566	IN.	OUT PER.	319.2	MM.
C.C.D.	4.000	IN.	C.C.D.	101.600	MM.
FINISH		M/F	ALLOY		
CKD BY	FACTOR 7	SCALE 1:1	DWN BY C.P.	DATE 04/08/2008	

CAN ART

ALUMINUM EXTRUSION INC.

85 PARKSHORE DRIVE
BRAMPTON, ONT L6T 5M1
TEL. NO. (905) 791-1464
FAX NO. (905) 791-9151
WEB: www.canart.com

THIS DRAWING IS NOT NECESSARILY A COPY OF YOUR ORIGINAL. PLEASE APPROVE DIMENSIONS AND TOLERANCES INDICATED. CAN ART ASSUMES NO RESPONSIBILITY EITHER TECHNICAL OR LEGAL FOR HAVING THIS SHAPE MADE. THE CUSTOMER AGREES TO FULLY PROTECT CAN ART ALUMINUM FROM CLAIMS OF OTHERS RESULTING FROM THIS SHAPE.

SIGNED: _____ DATE: _____