

NOTE: BREAK ALL CORNERS WITH 0.015" (.38 MM) RADIUS UNLESS OTHERWISE NOTED. STANDARD TOLERANCES TO APPLY UNLESS OTHERWISE SPECIFIED.

CUSTOMER CAN ART STD.		DIE No. EH05856	REV. No. 1
DESCRIPTION 4.000 x 2.000 x .125 REC. TUBE	CUSTOMER PART No.	QUOTE No. L07-0442-1	PROPOSAL No. H-55588

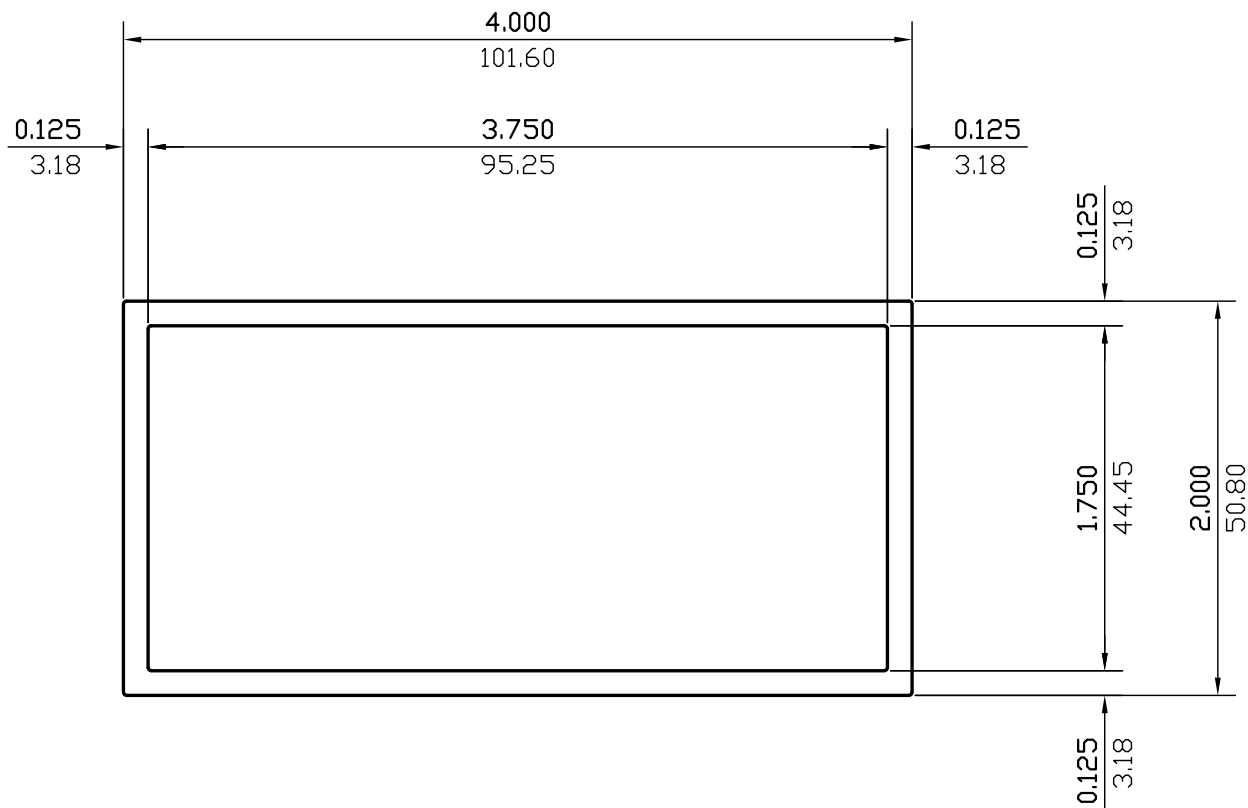

WALL THICKNESS 0.125(3.18) EXCEPT AS SHOWN

DATE	REV	DESCRIPTION				BY			
03/14/23	1	REMOVED ALLOY				JASON			
EST.AREA		1.437	IN. ²	EST.AREA		927.425	MM. ²		
EST.WT.		1.725	LBS/FT.	EST.WT.		2.567	KG/M.		
EST.PER.		22.948	IN.	EST.PER.		582.892	MM.		
OUT PER.		11.974	IN.	OUT PER.		304.1	MM.		
C.C.D.		4.459	IN.	C.C.D.		113.254	MM.		
FINISH				M/F				ALLOY	
CKD BY		FACTOR 13		SCALE 1:1		DWN BY L.G.		DATE 01/03/2008	

CAN ART

ALUMINUM EXTRUSION INC.

428 JUTRAS DRIVE S.
WINDSOR, ON N8N 5C5
TEL. NO. (519) 727-4399
FAX NO. (519) 727-6434
WEB: www.canart.com

THIS DRAWING IS NOT NECESSARILY A COPY OF YOUR ORIGINAL. PLEASE APPROVE DIMENSIONS AND TOLERANCES INDICATED. CAN ART ASSUMES NO RESPONSIBILITY EITHER TECHNICAL OR LEGAL FOR HAVING THIS SHAPE MADE. THE CUSTOMER AGREES TO FULLY PROTECT CAN ART ALUMINUM FROM CLAIMS OF OTHERS RESULTING FROM THIS SHAPE.

SIGNED: _____ DATE: _____