

CUSTOMER

CAN ART STD.

DIE No.

EH05809

REV. No.

1

DESCRIPTION

2.000 O.D. x 0.250 THK. ROUND TUBE

CUSTOMER PART No.

PROPOSAL No.

H-15518

NOTE: BREAK ALL CORNERS WITH 0.015" (.38 MM) RADIUS UNLESS OTHERWISE NOTED. STANDARD TOLERANCES TO APPLY UNLESS OTHERWISE SPECIFIED.

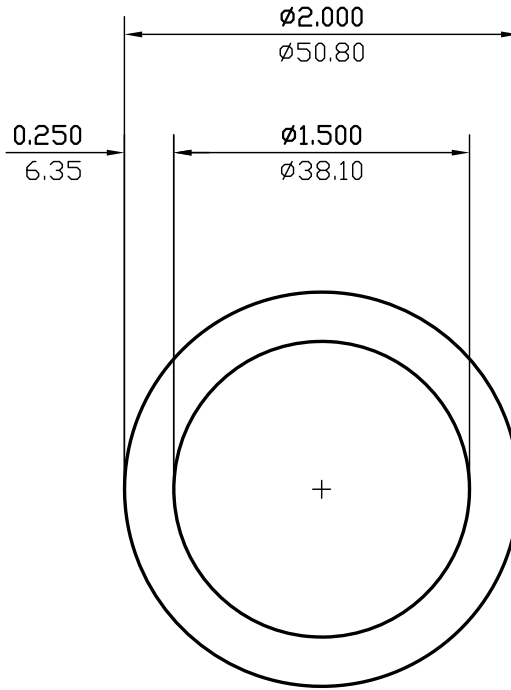

WALL THICKNESS 0.250 (6.35) EXCEPT AS SHOWN

DATE	REV	DESCRIPTION	BY
03/10/23	1	REMOVED ALLOY	JASON
EST.AREA	1.374	IN. ²	EST.AREA 886.745
			MM. ²
EST.WT.	1.622	LBS/FT.	EST.WT. 2.414
			KG/M.
EST.PER.	10.996	IN.	EST.PER. 279.288
			MM.
OUT PER.	6.283	IN.	OUT PER. 159.6
			MM.
C.C.D.	2.000	IN.	C.C.D. 50.800
			MM.
FINISH	M/F		ALLOY
CKD BY	FACTOR 7	SCALE 1:1	DWN BY P.M. DATE 02/18/2005

CAN ART

ALUMINUM EXTRUSION INC.

85 PARKSHORE DRIVE
BRAMPTON, ONT L6T 5M1
TEL. NO. (905) 791-1464
FAX NO. (905) 791-9151
WEB: www.canart.com

THIS DRAWING IS NOT NECESSARILY A COPY OF YOUR ORIGINAL. PLEASE APPROVE DIMENSIONS AND TOLERANCES INDICATED. CAN ART ASSUMES NO RESPONSIBILITY EITHER TECHNICAL OR LEGAL FOR HAVING THIS SHAPE MADE. THE CUSTOMER AGREES TO FULLY PROTECT CAN ART ALUMINUM FROM CLAIMS OF OTHERS RESULTING FROM THIS SHAPE.

SIGNED: _____ DATE: _____