

NOTE: BREAK ALL CORNERS WITH 0.015" (.38 MM) RADIUS UNLESS OTHERWISE NOTED. STANDARD TOLERANCES TO APPLY UNLESS OTHERWISE SPECIFIED.

CUSTOMER PART No.	CUSTOMER CAN ART STD.	DIE No. EH05694
DESCRIPTION	4 x 2 x 3/16 S.C. RECT. TUBE	PROPOSAL No. H-10663

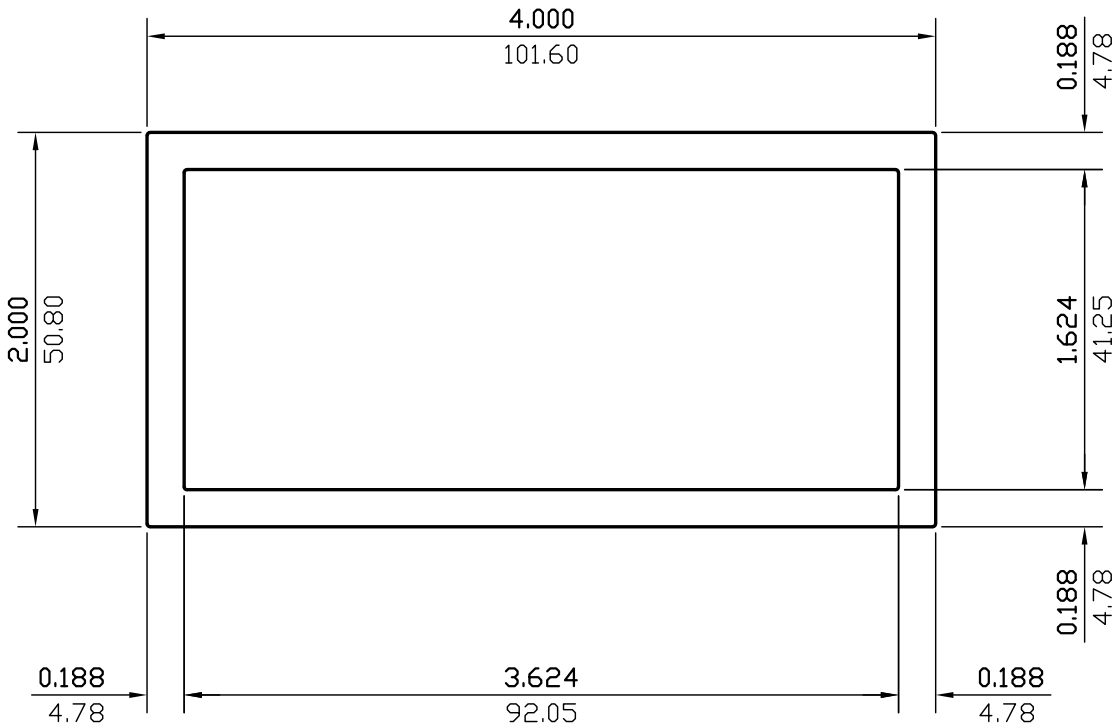

WALL THICKNESS (AS SHOWN) EXCEPT AS SHOWN

DATE	REV	DESCRIPTION	BY
03/14/23	1	REMOVED ALLOY	JASON
EST.AREA	2.115	IN. ²	EST.AREA 1364.282
EST.WT.	2.495	LBS/FT.	EST.WT. 3.713
EST.PER.	22.496	IN.	EST.PER. 571.398
OUT PER.	12.000	IN.	OUT PER. 304.8
C.C.D.	4.472	IN.	C.C.D. 113.592
FACTOR	9	FINISH	M/F
CKD BY	SCALE	1:1	DWN BY C.P. DATE 01/15/2001

CAN ART

ALUMINUM EXTRUSION INC.

85 PARKSHORE DRIVE
BRAMPTON, ONT L6T 5M1
TEL. NO. (905) 791-1464
FAX NO. (905) 791-9151
E-MAIL: canart@canart.com

THIS DRAWING IS NOT NECESSARILY A COPY OF YOUR ORIGINAL. PLEASE APPROVE DIMENSIONS AND TOLERANCES INDICATED. CAN ART ASSUMES NO RESPONSIBILITY EITHER TECHNICAL OR LEGAL FOR HAVING THIS SHAPE MADE. THE CUSTOMER AGREES TO FULLY PROTECT CAN ART ALUMINUM FROM CLAIMS OF OTHERS RESULTING FROM THIS SHAPE.

SIGNED: _____ DATE: _____