

CUSTOMER

CAN ART STD.

DIE No.

EH05524

REV. No.

1

DESCRIPTION

2.500" O.D. x 0.125" THK. ROUND TUBE

CUSTOMER PART No.

PROPOSAL No.

H-5755

NOTE: BREAK ALL CORNERS WITH 0.015" (.38 MM) RADIUS UNLESS OTHERWISE NOTED. STANDARD TOLERANCES TO APPLY UNLESS OTHERWISE SPECIFIED.

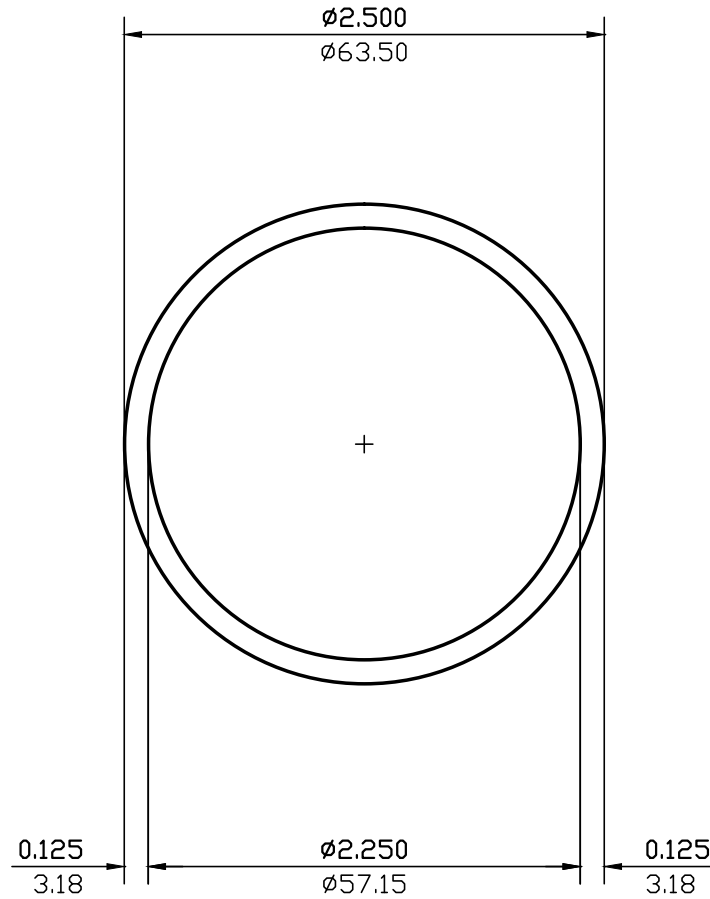

WALL THICKNESS 0.125 (3.18) EXCEPT AS SHOWN

DATE	REV	DESCRIPTION		BY	
EST.AREA	0.933	IN. ²	EST.AREA	601.720	MM. ²
EST.WT.	1.101	LBS/FT.	EST.WT.	1.638	KG/M.
EST.PER.	14.923	IN.	EST.PER.	379.033	MM.
OUT PER.	7.854	IN.	OUT PER.	199.5	MM.
C.C.D.	2.500	IN.	C.C.D.	63.500	MM.
FINISH	M/F		ALLOY	6061	
CKD BY	FACTOR 14	SCALE 1:1	DWN BY P.M.	DATE 09/05/1996	

CAN ART

85 PARKSHORE DRIVE
BRAMPTON, ONT L6T 5M1
TEL. NO. (905) 791-1464
FAX NO. (905) 791-9151
WEB: www.canart.com

ALUMINUM EXTRUSION INC.

THIS DRAWING IS NOT NECESSARILY A COPY OF YOUR ORIGINAL. PLEASE APPROVE DIMENSIONS AND TOLERANCES INDICATED. CAN ART ASSUMES NO RESPONSIBILITY EITHER TECHNICAL OR LEGAL FOR HAVING THIS SHAPE MADE. THE CUSTOMER AGREES TO FULLY PROTECT CAN ART ALUMINUM FROM CLAIMS OF OTHERS RESULTING FROM THIS SHAPE.

SIGNED: _____ DATE: _____