

CUSTOMER PART No.

CUSTOMER

CAN ART STD.

DIE No.

EH05520

DESCRIPTION

2.500" O.D. x 0.083" THK. ROUND TUBE

PROPOSAL No.

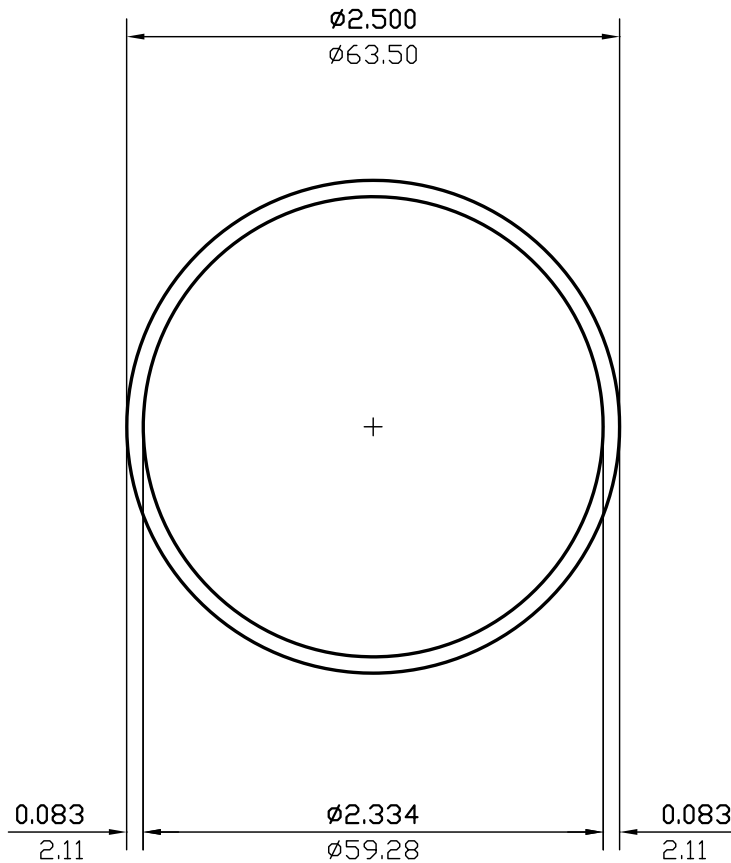
H-5633WALL THICKNESS **0.083 (2.11)** EXCEPT AS SHOWN

| DATE | REV | DESCRIPTION | BY | | | |
|----------|---------------|------------------|------------|---------------|------------------|-----------------|
| 03/10/23 | 2 | REMOVED ALLOY | JASON | | | |
| 08/05/99 | 1 | REDRAWN | P.M. | | | |
| EST.AREA | 0.630 | IN. ² | EST.AREA | 407 | MM. ² | |
| EST.WT. | 0.744 | LBS/FT. | EST.WT. | 1.107 | KG/M. | |
| EST.PER. | 15.186 | IN. | EST.PER. | 385.7 | MM. | |
| OUT PER. | 7.854 | IN. | OUT PER. | 199.5 | MM. | |
| C.C.D. | 2.500 | IN. | C.C.D. | 64 | MM. | |
| FACTOR | 20 | FINISH | M/F | ALLOY & TEMP. | | |
| CKD BY | SCALE | 1:1 | DWN BY | C.P. | DATE | 06/17/96 |

CAN ART

ALUMINUM EXTRUSION INC.

85 PARKSHORE DRIVE
BRAMPTON, ONT L6T 5M1
TEL. NO. (905) 791-1464
FAX NO. (905) 791-9151
E-MAIL: canart@canart.com

THIS DRAWING IS NOT NECESSARILY A COPY OF YOUR ORIGINAL. PLEASE APPROVE DIMENSIONS AND TOLERANCES INDICATED. CAN ART ASSUMES NO RESPONSIBILITY EITHER TECHNICAL OR LEGAL FOR HAVING THIS SHAPE MADE. THE CUSTOMER AGREES TO FULLY PROTECT CAN ART ALUMINUM FROM CLAIMS OF OTHERS RESULTING FROM THIS SHAPE.

SIGNED: _____ DATE: _____

NOTE: BREAK ALL CORNERS WITH 0.015" (.38 MM) RADIUS UNLESS OTHERWISE NOTED. STANDARD TOLERANCES TO APPLY UNLESS OTHERWISE SPECIFIED.