

NOTE: BREAK ALL CORNERS WITH 0.015" (.38 MM) RADIUS UNLESS OTHERWISE NOTED. STANDARD TOLERANCES TO APPLY UNLESS OTHERWISE SPECIFIED.

CUSTOMER PART No.	CUSTOMER <b>CAN ART STD.</b>	DIE No. <b>EH05404</b>
DESCRIPTION 0.750" O.D. x 0.050" THK. ROUND TUBE		PROPOSAL No. H-2667

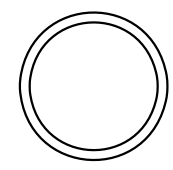
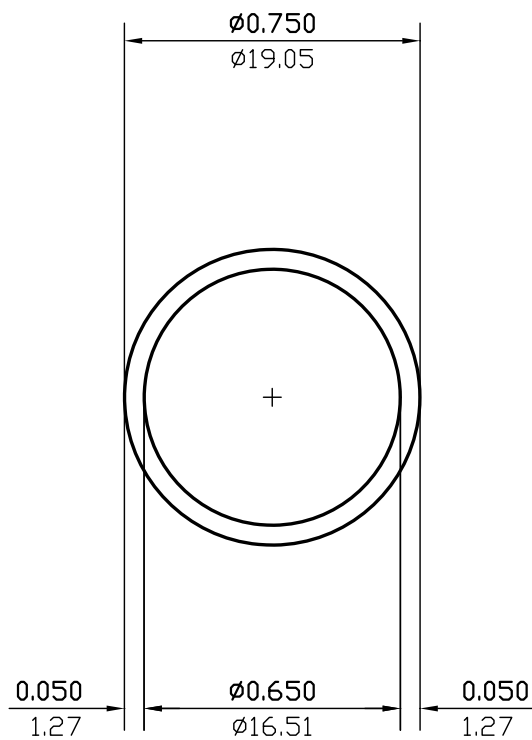

ACTUAL SIZE

WALL THICKNESS 0.050 (1.27) EXCEPT AS SHOWN

DATE	REV	DESCRIPTION	BY		
03/10/23	2	REMOVED ALLOY	JASON		
08/03/99	1	REDRAWN	P.M.		
EST.AREA	0.110	IN. <sup>2</sup>	EST.AREA	71	MM. <sup>2</sup>
EST.WT.	0.130	LBS/FT.	EST.WT.	0.193	KG/M.
EST.PER.	4.398	IN.	EST.PER.	111.7	MM.
OUT PER.	2.356	IN.	OUT PER.	59.8	MM.
C.C.D.	0.750	IN.	C.C.D.	19	MM.
FACTOR	34	FINISH	M/F	ALLOY & TEMP.	
CKD BY		SCALE	2:1	DWN BY	C.P.
		DATE	11/03/92		

# CAN ART

ALUMINUM EXTRUSION INC.

85 PARKSHORE DRIVE  
BRAMPTON, ONT L6T 5M1  
TEL. NO. (905) 791-1464  
FAX NO. (905) 791-9151  
E-MAIL: canart@canart.com

THIS DRAWING IS NOT NECESSARILY A COPY OF YOUR ORIGINAL. PLEASE APPROVE DIMENSIONS AND TOLERANCES INDICATED. CAN ART ASSUMES NO RESPONSIBILITY EITHER TECHNICAL OR LEGAL FOR HAVING THIS SHAPE MADE. THE CUSTOMER AGREES TO FULLY PROTECT CAN ART ALUMINUM FROM CLAIMS OF OTHERS RESULTING FROM THIS SHAPE.

SIGNED: \_\_\_\_\_ DATE: \_\_\_\_\_