

NOTE: BREAK ALL CORNERS WITH 0.015" (.38 MM) RADIUS UNLESS OTHERWISE NOTED. STANDARD TOLERANCES TO APPLY UNLESS OTHERWISE SPECIFIED.

CUSTOMER PART No.	CUSTOMER CAN ART STD.	DIE No. EH05315
DESCRIPTION 2" SCHEDULE 80 PIPE		PROPOSAL No.

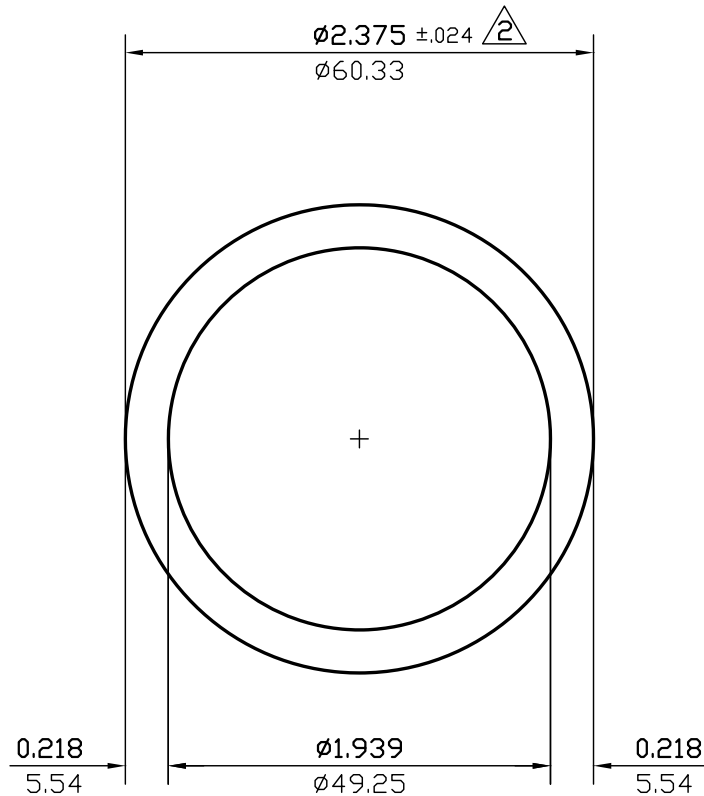

WALL THICKNESS 0.218 (5.54) EXCEPT AS SHOWN

DATE	REV	DESCRIPTION		BY		
03/10/23	3	REMOVED EXPOSED SURFACES AND ALLOY		JASON		
07/13/15	2	ADDED ±.024 TOLERANCE. REMOVED HOUSING/INSERT NOTE.		P.M.		
EST.AREA		1.477	IN. ²	EST.AREA	953	MM. ²
EST.WT.		1.743	LBS/FT.	EST.WT.	2.594	KG/M.
EST.PER.		13.553	IN.	EST.PER.	344.2	MM.
OUT PER.		7.461	IN.	OUT PER.	189.5	MM.
C.C.D.		2.375	IN.	C.C.D.	60	MM.
FACTOR 8		FINISH M/F		ALLOY & TEMP.		
CKD BY		SCALE 1:1		DWN BY J.D.	DATE 02/28/92	

CAN ART

ALUMINUM EXTRUSION INC.

85 PARKSHORE DRIVE
BRAMPTON, ONT L6T 5M1
TEL. NO. (905) 791-1464
FAX NO. (905) 791-9151
E-MAIL: canart@canart.com

THIS DRAWING IS NOT NECESSARILY A COPY OF YOUR ORIGINAL. PLEASE APPROVE DIMENSIONS AND TOLERANCES INDICATED. CAN ART ASSUMES NO RESPONSIBILITY EITHER TECHNICAL OR LEGAL FOR HAVING THIS SHAPE MADE. THE CUSTOMER AGREES TO FULLY PROTECT CAN ART ALUMINUM FROM CLAIMS OF OTHERS RESULTING FROM THIS SHAPE.

SIGNED: _____ DATE: _____