

NOTE: BREAK ALL CORNERS WITH 0.015" (.38 MM) RADIUS UNLESS OTHERWISE NOTED. STANDARD TOLERANCES TO APPLY UNLESS OTHERWISE SPECIFIED.

CUSTOMER PART No.	CUSTOMER CAN ART STD.	DIE No. EH05236
DESCRIPTION	2" SCHEDULE 40 PIPE	PROPOSAL No. H-1718

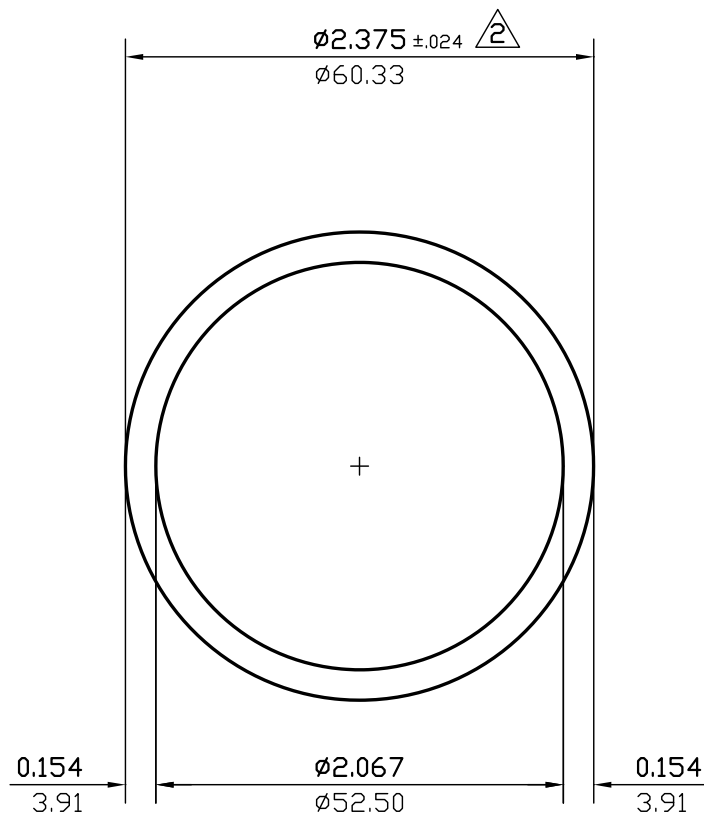

WALL THICKNESS 0.154 (3.91) EXCEPT AS SHOWN

DATE	REV	DESCRIPTION	BY
03/10/23	3	REMOVED ALLOY	JASON
07/13/15	2	REVISED TOLERANCE FROM ±.025 TO ±.024. REMOVED HOUSING/INSERT NOTE.	P.M.
EST.AREA	1.075	IN. ²	EST.AREA 693
EST.WT.	1.268	LBS/FT.	EST.WT. 1.887
EST.PER.	13.955	IN.	EST.PER. 354.5
OUT PER.	7.461	IN.	OUT PER. 189.5
C.C.D.	2.375	IN.	C.C.D. 60
FACTOR 11	FINISH M/F	ALLOY & TEMP.	
CKD BY	SCALE 1:1	DWN BY G.M.	DATE 10/01/90

CAN ART

ALUMINUM EXTRUSION INC.

85 PARKSHORE DRIVE
BRAMPTON, ONT L6T 5M1
TEL. NO. (905) 791-1464
FAX NO. (905) 791-9151
E-MAIL: canart@canart.com

THIS DRAWING IS NOT NECESSARILY A COPY OF YOUR ORIGINAL. PLEASE APPROVE DIMENSIONS AND TOLERANCES INDICATED. CAN ART ASSUMES NO RESPONSIBILITY EITHER TECHNICAL OR LEGAL FOR HAVING THIS SHAPE MADE. THE CUSTOMER AGREES TO FULLY PROTECT CAN ART ALUMINUM FROM CLAIMS OF OTHERS RESULTING FROM THIS SHAPE.

SIGNED: _____ DATE: _____