

CUSTOMER PART No.	CUSTOMER	CAN ART STD.	DIE No.
			EH05048
DESCRIPTION	2.500" O.D. x 0.065" THK. ROUND TUBE		PROPOSAL No.

NOTE: BREAK ALL CORNERS WITH 0.015" (.38 MM) RADIUS UNLESS OTHERWISE NOTED. STANDARD TOLERANCES TO APPLY UNLESS OTHERWISE SPECIFIED.

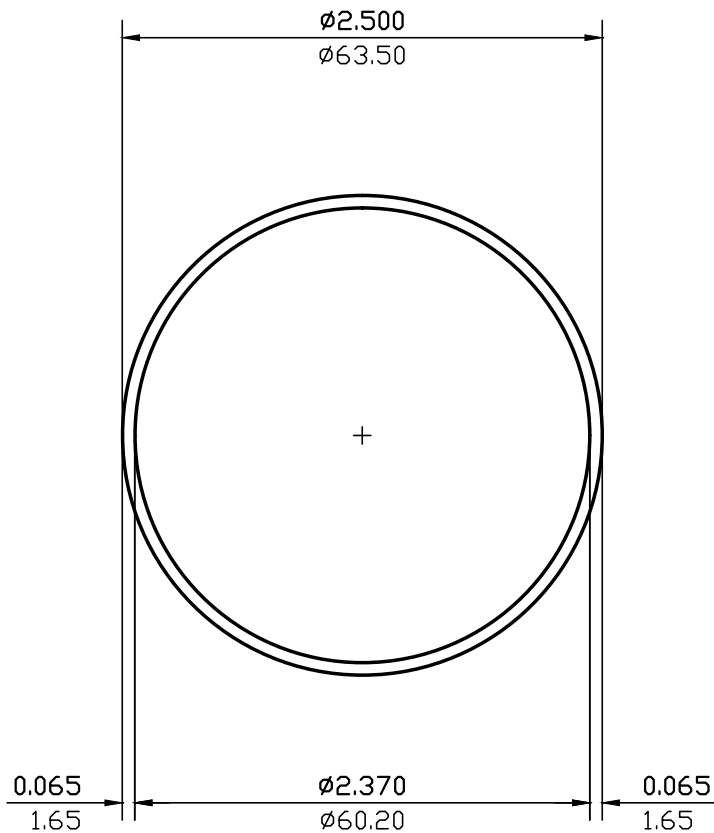

WALL THICKNESS 0.065 (1.65) EXCEPT AS SHOWN

DATE	REV	DESCRIPTION	BY
EST.AREA	0.497	IN. ²	EST.AREA 321
EST.WT.	0.587	LBS/FT.	EST.WT. 0.873
EST.PER.	15.300	IN.	EST.PER. 388.6
OUT PER.	7.854	IN.	OUT PER. 199.5
C.C.D.	2.500	IN.	C.C.D. 64
FACTOR	26	FINISH M/F	ALLOY & TEMP. 6063/6061/6351
CKD BY	SCALE 1:1	DWN BY C.P.	DATE 07/21/93

CAN ART

85 PARKSHORE DRIVE
BRAMPTON, ONT L6T 5M1
TEL. NO. (905) 791-1464
FAX NO. (905) 791-9151
E-MAIL: canart@canart.com

ALUMINUM EXTRUSION INC.

THIS DRAWING IS NOT NECESSARILY A COPY OF YOUR ORIGINAL. PLEASE APPROVE DIMENSIONS AND TOLERANCES INDICATED. CAN ART ASSUMES NO RESPONSIBILITY EITHER TECHNICAL OR LEGAL FOR HAVING THIS SHAPE MADE. THE CUSTOMER AGREES TO FULLY PROTECT CAN ART ALUMINUM FROM CLAIMS OF OTHERS RESULTING FROM THIS SHAPE.

SIGNED: _____ DATE: _____