

NOTE: BREAK ALL CORNERS WITH 0.015" (.38 MM) RADIUS UNLESS OTHERWISE NOTED. STANDARD TOLERANCES TO APPLY UNLESS OTHERWISE SPECIFIED.

CUSTOMER CAN ART OPEN		DIE No. ES16976	REV. No. 2
DESCRIPTION CLAMP	CUSTOMER PART No.	QUOTE No. L12-0706-R-2	PROPOSAL No. S-62506

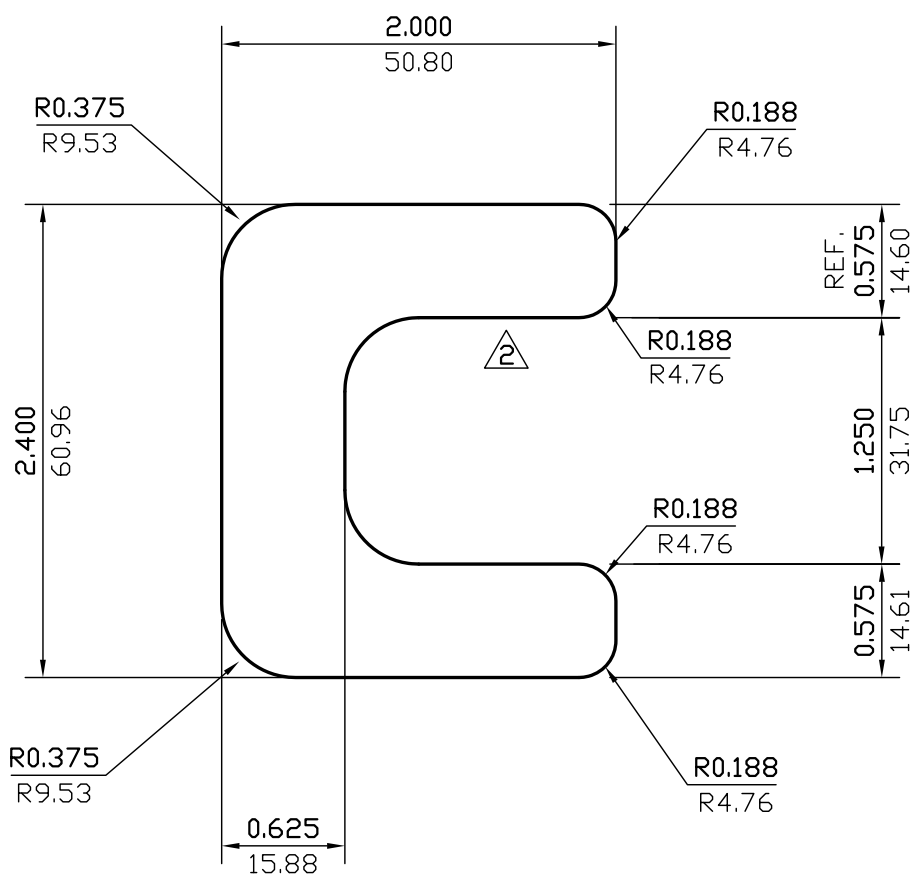

**6061 T6 TYPE 2
SECONDARY BILLET
ONLY**

WALL THICKNESS (AS SHOWN) EXCEPT AS SHOWN

DATE	REV	DESCRIPTION	BY
07/31/13	2	REMOVED TEETH.	PAUL

EST.AREA	3.051	IN. ²	EST.AREA	1968.445	MM. ²
EST.WT.	3.600	LBS/FT.	EST.WT.	5.358	KG/M.
EST.PER.	10.584	IN.	EST.PER.	268.841	MM.
OUT PER.		IN.	OUT PER.		MM.
C.C.D.	2.899	IN.	C.C.D.	73.627	MM.
FINISH	M/F		ALLOY	6061	
CKD BY	FACTOR 3	SCALE 1:1	DWN BY G.W.	DATE 08/29/2012	

CAN ART

428 JUTRAS DRIVE S.
WINDSOR, ON N8N 5C5
TEL. NO. (519) 727-4399
FAX NO. (519) 727-6434
WEB: www.canart.com

ALUMINUM EXTRUSION INC.

THIS DRAWING IS NOT NECESSARILY A COPY OF YOUR ORIGINAL. PLEASE APPROVE DIMENSIONS AND TOLERANCES INDICATED. CAN ART ASSUMES NO RESPONSIBILITY EITHER TECHNICAL OR LEGAL FOR HAVING THIS SHAPE MADE. THE CUSTOMER AGREES TO FULLY PROTECT CAN ART ALUMINUM FROM CLAIMS OF OTHERS RESULTING FROM THIS SHAPE.

SIGNED: _____ DATE: _____